



PRODUCT CATALOG



"The Choice of Professionals"

Aslan Paint: From Past to Present	4-7
Quality Certificates	8-9
European Standards	10-13

PAINT GROUP

Interior Paints & Primers	16-18
Interior Paints & Primers	19-20
Exterior Paints & Primers	20-25
Exterior Paints & Primers	26-28
Pastes	29-30
Special Purpose Products	31
Synthetic Paints and Primers	32-33
Wood Paints and Protector	34-35
Industrial Paints and Primers	36-37
Thinners	38-39

CONSTRUCTION CHEMICALS GROUP

Adhesive Mortars	42-44
Joint Filling Products	45
Cement-Based Plasters	46-49
Gloss Surface Plasters	50-51
Gypsum Board Plasters	52-53
Insulation	54-59
Primers	60-61
Gypsum and Spray Products	62
Concrete Repair and Grout Mortars	63-64
Mortar Additives	65
Waterproofing Products	66-72
Consumption Tables	73

FLOORING SYSTEMS

Concrete Floor Cleaning Systems	76-77
Industrial Flooring Systems	78-81
Stamped Concrete and Wall Systems	82-88
Concrete Strengthening	89

MACHINE AND HAND-APPLIED PLASTER GROUP

Cement-Based Plasters	92-95
Cement-Based Machine Plasters	96-97

DECORATIVE COATINGS AND EFFECT GROUP

Exterior Coatings	100
Decorative Topcoat Plasters	101
Effect Group Products	102-109

HISTORICAL ARTIFACT RESTORATION PRODUCTS

Historical Artifact Restoration Products	110-15
--	--------

From past to present: Aslan Boya

Our History

The creator of our brand, Ahmet Ozerman, was born in 1952 in the village of Dali in Southern Cyprus. He began working in construction at an early age, dedicating himself to the sector by working his way up from an apprentice to a master craftsman. Specializing particularly in exterior coatings and tile and ceramic adhesives, he soon became the most recognized figure in this field on the island. In 1963, he gained international experience working on hotel projects in Israel as an applicator for Santex, a company exporting from Southern Cyprus. Although he always harbored a strong desire to manufacture his own products, his efforts to establish a facility were hindered at the time.

Following the 1974 Peace Operation, Ahmet Ozerman relocated to Northern Cyprus. He continued his contracting work by importing necessary materials from abroad until he could establish his own local production facilities. In 1977, under challenging conditions, his first facility became operational in Akdogan (Lisi), where he began production under a simple shed using just a sieve and a concrete mixer. By 1982, his operations had expanded enough to move to a proper factory in the Nicosia Organized Industrial Zone.

Initially, a large portion of the manufactured products was applied directly by our in-house professional teams on a project basis, while the remainder was sold to the domestic market. This dual approach quickly established our brand's reputation in the construction sector. Driven by strict discipline and a "quality first" policy, our brand ASLAN was officially registered in 1986, operating under the name Ahmet Ozerman LTD. By acquiring technical know-how from Europe, particularly Germany, we pioneered the use of German technology in Cyprus for building materials, cement-based plasters, and paints. This breakthrough allowed us to elevate our product variety and quality, introducing first-of-their-kind solutions to the local construction industry's challenges.

Ahmet Ozerman LTD continually upgraded its production capacity, offering standardized, high-quality goods to the market every day. As the largest producer in our country—boasting 90 types of products and 360 packaging variations—the company accelerated its research and development by establishing an in-house quality control laboratory. This growth led to the opening of a second facility, the Aslan Integrated Powder Production Facility, in 2001. A year later, Ahmet Ozerman LTD achieved a major milestone by becoming the first TSE-certified (Turkish Standards Institution) paint and adhesive manufacturer in the Turkish Republic of Northern Cyprus.





From past to present: Aslan Boya

The Present Day

In 2011, with the vision of passing the production legacy from father to son, BMP TRADE LTD took over the mantle as the second-generation manufacturing company under the management of Suleyman Ozerman and Elif Ozerman. Operating out of the Heavy Industrial Zone in Minarelikoy, Nicosia, the company now focuses exclusively on the production, research, and development of the ASLAN brand.

Today, BMP TRADE LTD continues its operations with a dedicated team of approximately 30 employees, making a significant contribution to the national economy. Unwavering in its "Quality First" approach, the company's ultimate goal is to establish a strong presence in the international market. Beyond manufacturing, BMP TRADE LTD closely monitors field applications, offering technical consultancy and free training to ensure customers achieve the best results with new products. All production is carried out in strict accordance with Turkish and European standards, alongside ISO 9001:2015, ISO 14001:2015, ISO 10002, ISO 50001, and ISO 45001 certifications.





Our Mission

- To prove that world-class, high-quality products can be produced in our country.
- To transition from a purely consuming society to a producing one, distinguishing ourselves in the process.
- To make our brand the most preferred choice in our domestic market.
- To expand globally, creating lasting value for our country and society.
- To reduce foreign dependency by offering innovative, high-quality solutions to the local construction sector.
- To maintain environmentally friendly and sustainable production practices.
- To provide reliable technical support and consultancy services.

Our Vision

- To proactively capture change and embrace continuous improvement.
- To foster a deep understanding of quality throughout the entire company structure.
- To remain transparent, reliable, and open in all our dealings.
- To train expert employees who can guide our customers effectively.
- To execute tasks correctly the very first time.
- To encourage employee development and practice collaborative decision-making.
- To instill a sense of ownership, ensuring everyone embraces the "The company is us" mentality.



ISO SYSTEM CERTIFICATES

ISO 9001:2015 Quality Management System Certificate

ISO 14001:2015 Environmental Management System Certificate

ISO 45001:2018 Occupational Health and Safety Management System Certificate

ISO 50001:2018 Energy Management System Certificate

ISO 10002:2018 Customer Satisfaction Management System Certificate



FUK DOCUMENTS

CONCRETE AND MORTAR ADDITIVES

EN 934-2 Concrete and Mortar Additives Certificates

EN 934-3 Concrete and Mortar Additive Products Certificates

JOINT FILLING PRODUCTS CERTIFICATES

EN 13888 Joint Filling Products Standards

ADHESIVE PRODUCTS FUK DOCUMENTS

EN 12004-1 Adhesive Products FUK Certificates

PLASTER GROUP PRODUCTS FUK DOCUMENTS

EN 998-1 Plaster Group-1 Products FUK Certificates

EN 998-1 Plaster Group-2 Products FUK Certificates

EN 998-1 Plaster Group-3 Products FUK Certificates

EN 998-1 Plaster Group-4 Products FUK Certificates

EN 998-1 Plaster Group-5 Products FUK Certificates

EN 998-2 Plaster Group Products FUK Certificates

PAINT GROUP PRODUCTS FUK DOCUMENTS

TS 5808 Paint Products Manufacturing Standards Certificates

TS 39 Paint Products Manufacturing Standards Certificates

TS 7847 Paint Products Manufacturing Standards Certificates



TO VIEW OUR
ISO SYSTEM AND
FUK DOCUMENTS,
PLEASE SCAN THE QR
CODE.





EUROPEAN STANDARDS & CERTIFICATIONS

TILE ADHESIVES

EN 12004-1

PLASTERS - MASONRY MORTARS

EN 998-1/2

REPAIR MORTARS

EN 1504-3

PRODUCTS FOR THE PROTECTION OF CONCRETE STRUCTURES

EN 1504-2

SCREED AND FLOOR COVERING MATERIALS

EN 13813

ORGANIC BINDING EXTERIOR AND INTERIOR PLASTER

ACRYLIC AND SILICONE BASED COATINGS

EN 15824

EUROPEAN STANDARDS SPECIFICATIONS, TEST METHODS, REQUIREMENTS

TILE ADHESIVES

EN 12004

	Feature	Test Method	Requirements
C1 (Normal setting cement adhesive)	Tensile adhesion strength (after 28 days)	EN 1348 (standard conditions)	$\geq 0.5 \text{ N/mm}^2$
		EN 1348 (after the heating process)	$\geq 0.5 \text{ N/mm}^2$
		EN 1348 (after being submerged in water)	$\geq 0.5 \text{ N/mm}^2$
		EN 1348 (after freeze-thaw cycles)	$\geq 0.5 \text{ N/mm}^2$
	Exposure Time	EN 12004-2 §8.1	$\geq 20 \text{ min.}$
C2 (improved cement adhesive)	Tensile adhesion strength (after 28 days)	EN 1348 (standard conditions)	$\geq 1 \text{ N/mm}^2$
		EN 1348 (after the heating process)	$\geq 1 \text{ N/mm}^2$
		EN 1348 (after being submerged in water)	$\geq 1 \text{ N/mm}^2$
		EN 1348 (after freeze-thaw cycles)	$\geq 1 \text{ N/mm}^2$
	Exposure Time	EN 12004-2 §8.1	$\geq 20 \text{ min.}$
F (fast-setting cement adhesive)	Tensile adhesion strength (after 6 hours)	EN 1348 (standard conditions)	$\geq 0.5 \text{ N/mm}^2$
	Exposure Time	EN 12004-2 §8.1	$\geq 0.5 \text{ N/mm}^2$ 10 minutes later



Additional Features

Feature	Test Method	Requirements
T (vertical shift)	EN 12004-2 §8.2	$\leq 0.5 \text{ mm}$
E (Extended open time tensile adhesion strength)	EN 12004-2 §8.1	$\geq 0.5 \text{ N/mm}^2$ 30 minutes later
S1 (Deformable adhesive, transverse deformation)	EN 12004-2 §8.6	$2.5 \text{ mm} \leq S1 \leq 5 \text{ mm}$
(High Deformation Adhesive, Transverse deformation)	EN 12004-2 §8.6	$\geq 5 \text{ mm}$

PLASTERS - MORTARS

EN 998 - 1/2



Plaster/exterior coating mortars are defined according to their properties and/or intended use.	
GP	General Purpose Plaster Mortar
LW	Lightweight Plaster Mortar
T	Thermal Insulation Mortar
R	Renovation Mortar
CR	Colored Plaster Mortar
OC	Single Layer Plaster Mortar

Mortar Classification according to EN 998-2			
Feature	Categories	Test Method	Values
Compressive Strength Range (After 28 days)	EN 1015-11	M 1	1 N/mm ²
		M 2.5	2.5 N/mm ²
		M 5	5 N/mm ²
		M 10	10 N/mm ²
		M 15	15 N/mm ²
		M 20	20 N/mm ²
		M d	d ($\geq 20 \text{ N/mm}^2$)

EUROPEAN STANDARDS

FEATURES, TESTING METHODS, REQUIREMENTS

REPAIR FEES

EN 1504-3



Performance requirements for repair mortars according to EN 1504-3					
Performance Features	Test Method	Necessity			
		R1	R2	R3	R4
Bond strength (after 28 days)	EN 1542	≥ 0.8 N/mm ²	≥ 0.8 N/mm ²	≥ 1.5 N/mm ²	≥ 2 N/mm ²
Compressive Strength (After 28 days)	EN 12190	≥ 10/mm ²	≥ 15/mm ²	≥ 25 N/mm ²	≥ 45 N/mm ²
Elastic Modulus	EN 13412	-	-	≥ 15 kN/mm ²	≥ 20 kN/mm ²
Capillary Absorption	EN 13057	-	≤ 0.5 Kg/m ² h ^{0.5}	≤ 0.5 Kg/m ² h ^{0.5}	≤ 0.5 Kg/m ² h ^{0.5}
Thermal Compatibility -Part I, freeze-thaw measured as bond strength EN 1542: 50	EN 13687-1	-	≥ 0.8 N/mm ²	≥ 1.5 N/mm ²	≥ 2 N/mm ²

PRODUCTS FOR THE PROTECTION OF CONCRETE STRUCTURES

EN 1504-2



Performance requirements for surface protection mortars for concrete according to EN 1504-2 standard			
Performance Features	Test Method	Necessity	
Adhesion Strength (After 28 days)	EN 1542	For Flexible Systems with High Traffic Congestion ≥ 0,8 N/mm ² (0,5)	For Flexible Systems with High Traffic Congestion ≥ 1,5 N/mm ² (1)
Capillary Absorption and Water Permeability	EN 1062-3	w < 0.1 Kg/m ³ h ^{0.5}	
Permeability CO ²	EN 1062-6	Sd ≥ 50m	
Water Vapor Permeability	EN 7783-1	Class I Sd < 5m (permeability)	
		Class II 5m < Sd < 50m	
		Class III Sd > 5m (impassable)	

CEMENT ADDITIVES (CT)

EN 13813



Performance requirements for cementitious screeds (CT) according to EN 13813			
Features	Class	Test Method	Values
Bond Strength (After 28 days)	C20	EN 13892-2	≥ 20 N/mm ²
	C30		≥ 30 N/mm ²
	C40		≥ 40 N/mm ²
	C50		≥ 50 N/mm ²
Compressive Strength (After 28 days)	F4	EN 13892-2	≥ 4 N/mm ²
	F5		≥ 5 N/mm ²
	F6		≥ 6 N/mm ²
	F7		≥ 7 N/mm ²
	F10		≥ 10 N/mm ²

EXTERIOR AND INTERIOR PLASTERS BASED ON ORGANIC BINDERS (ACRYLIC AND SILICONE TEXTURE COATINGS)

EN 15824



Performance requirements for exterior and interior plasters based on organic binders according to EN 15824 standard		
Features	Test Method	Values
Water Vapor Permeability	EN 7783-2	V1 (high): $S_d < 0,14m$
		V2 (middle): $0,14 m \leq S_d < 1,4 m$
		V3 (low): $\geq 1,4 m$
Water Absorption	EN 1062-3	$W1 > 0.5 \text{ Kg/m}^2 \text{ h}^{0.5}$
		$0.1 < W2 \leq 0.5 \text{ Kg/m}^2 \text{ h}^{0.5}$
		$W3 \leq 0.1 \text{ Kg/m}^2 \text{ h}^{0.5}$
Adhesion	EN 1542	≥ 0.3 N/mm ²
Freeze-thaw resistance (applicable only to exterior plasters, $W > 0.5 \text{ kg/m}^2 \text{ h}^{0.5}$)	EN 13687-3	≥ 0.3 N/mm ²
Fire Response	EN 13501-1	Classes A1 to F



PAINT GROUP

- ▶ INTERIOR PAINTS
- ▶ INTERIOR PRIMERS
- ▶ EXTERIOR PAINTS
- ▶ EXTERIOR PRIMERS
- ▶ PASTE
- ▶ SPECIAL PURPOSE PRODUCTS
- ▶ SYNTHETIC PAINTS AND PRIMERS
- ▶ WOOD PAINTS AND PROTECTORS
- ▶ INDUSTRIAL PAINTS AND PRIMERS
- ▶ THINNERS

PEARL SHINE

TS 5808

- ▶ 100% Pure acrylic based.
- ▶ Washable and antibacterial.
- ▶ Glossy satin paint.
- ▶ Hygienic, stays clean at all times.
- ▶ Easy application, low odor.
- ▶ Colors do not fade.
- ▶ 1 liters cover 17 m².
- ▶ Dilute with 10-25% water.

Packaging: 15 L, 7.5 L, 2.5 L, 0.75 L



SILK MATTE

TS 5808

- ▶ 100% Pure acrylic based.
- ▶ Washable and antibacterial.
- ▶ Glossy satin paint.
- ▶ Hygienic, stays clean at all times.
- ▶ Easy application, low odor.
- ▶ 1 liters cover 17 m².
- ▶ Dilute with 10-25% water.

Packaging: 15 L, 7.5 L, 2.5 L, 0.75 L



SUPER PLASTIMAT

TS 5808

- ▶ Washable, matte.
- ▶ Antibacterial, silicone-based.
- ▶ High coverage area.
- ▶ Does not yellow.
- ▶ Low odor.
- ▶ 1 liters cover 12-14 m² of surface.
- ▶ On previously painted surfaces, 100m² can be painted with 2 coats using a 12L bucket.
- ▶ It is thinned with 10-20% water.
- ▶ It hides surface imperfections.

Packaging: 15 L, 7.5 L, 2.5 L, 0.75 L



SILICONE PLASTIMAT

TS 5808

- ▶ Erasable.
- ▶ Matte.
- ▶ Silicone coated.
- ▶ Odorless.
- ▶ 1 kg cover 7 m².
- ▶ Dilute with 10-20% water.

Packaging: 15 L, 7.5 L, 2.5 L, 0.75 L



EXTRA MATTE PLASTIC

TS 5808

- ▶ Erasable.
- ▶ Extra Mat.
- ▶ Silicone.
- ▶ Odorless.
- ▶ 1 kg cover 7 m².
- ▶ Dilute with 10-20% water.

Packaging: 15 L, 7.5 L, 2.5 L, 0.75 L



PLASTIMAT

TS 5808

- ▶ Erasable.
- ▶ Matte.
- ▶ Conceals surface imperfections.
- ▶ 1 kg cover 6 m².
- ▶ Dilute with 10-20% water.
- ▶ Provides excellent adhesion to all types of surfaces.

Packaging: 20 Kg, 10 Kg, 3Kg, 1 Kg,



PLASTIC

TS 5808

- ▶ Matte finish.
- ▶ High coverage.
- ▶ Economical price.
- ▶ 1 kg cover 5 m².
- ▶ Dilute with 10-20% water.
- ▶ Provides adhesion to all types of surfaces.

Packaging: 20 Kg, 10 Kg, 3Kg, 1 Kg,



MILLENNIUM NATURAL CEILING

- ▶ Allows ceilings to breathe.
- ▶ Matte finish.
- ▶ High coverage.
- ▶ 1 liters cover 5 m².
- ▶ Dilute with 10-20% water.

Packaging: 17 Kg,



MILLENNIUM EXTRA CEILING

- ▶ Allows ceilings to breathe.
- ▶ Mold preventative.
- ▶ Matte finish.
- ▶ High coverage.
- ▶ 1 liters cover 5 m².
- ▶ Dilute with 10-20% water.

Packaging: 17 Kg,



SUPER PLASTİMAT

- ▶ Wipeable, matte finish.
- ▶ Antibacterial, silicone-based.
- ▶ High coverage area.
- ▶ Does not yellow.



MULTISIL PRIMER

- ▶ Prevents salt efflorescence and stains seen in paint.
- ▶ Specially formulated for lime plasters.
- ▶ Used on previously unpainted surfaces.
- ▶ Semi-matte.
- ▶ Consumption: 0.40-0.60 lt/m².
- ▶ Ready to use, no dilution required.

Packaging: 15 L, 7.5 L, 2.5 L



NANOSIL PRIMER

- ▶ Prevents salt efflorescence and stains seen in paint.
- ▶ Used on previously painted surfaces.
- ▶ Nanotechnology.
- ▶ Semi-matte.
- ▶ Consumption: 0.40-0.60 lt/m².
- ▶ Ready to use, no dilution required.

Packaging: 15 L, 7.5 L, 2.5 L



PLASTEX IN PRIMER

- ▶ Interior surfaces.
- ▶ Extra white and high fill.
- ▶ Very high coverage.
- ▶ Primer for cement-based floors.
- ▶ Covers black surfaces in one go when transitioning from dark to light colors.
- ▶ Machine tinting possible.
- ▶ 1 kg cover 10 m².
- ▶ Dilute with at least 10% and at most 15% water.

Packaging: 20 Kg, 10 Kg, 3Kg, 1 Kg,



IZOSIL PRIMER BINDER

- ▶ 7/1 diluted insulation primer.
- ▶ For plaster and absorbent surfaces.
- ▶ Apply with one hand only.
- ▶ Must be thoroughly absorbed into the surface.
- ▶ Must not form a film layer.

Packaging: 15 L, 7.5 L, 2.5 L, 0.75 L



TRANSFERIX

- ▶ Provides a transition between water-based and solvent-based paints.
- ▶ Interior/exterior.
- ▶ Water-based.
- ▶ Suitable over oil-based paints.
- ▶ Has high adhesion to the surface.
- ▶ 1 liters primes approximately 17 m² of surface.
- ▶ Diluted by 10%.

Packaging: 12L, 7.5 L, 2.5 L, 0.75 L



UNIPER PRIMER

- ▶ Suitable for interior use.
- ▶ Nanotechnology product.
- ▶ Specially developed for cement-based Satenper satin plaster.
- ▶ Strengthens the Satenper plaster surface and prepares it for painting.
- ▶ Reduces paint consumption.
- ▶ Can be applied as a 7/1 primer on satin gypsum plaster.
- ▶ Depending on the absorbency of the surface, 1 liter can prime between 3.33 m² and 10 m² of surface.
- ▶ Ready to use. Do not dilute.

Packaging: 15L, 7.5 L, 2.5 L, 0.75 L



EXTERIOR PAINTS

SUNSHIELD SILFLEX FLAT

TS 7847



- ▶ Exterior, matte, non-yellowing
- ▶ 100% pure acrylic
- ▶ Long-lasting UV resistance
- ▶ Waterproof
- ▶ Odorless - High Coverage
- ▶ 1Lt cover 15m² surface
- ▶ Diluted with 10-15% water.
- ▶ Silicone-based.
- ▶ Long-lasting color.

Packaging: 15L, 7.5 L, 2.5 L, 0.75 L



SUNSHIELD FLAT SILK MATTE

TS 7847



- ▶ Exterior, matte, non-yellowing
- ▶ 100% pure acrylic
- ▶ Long-lasting UV resistance
- ▶ Waterproof
- ▶ 1Lt cover 15m² surface
- ▶ Diluted with 10-15% water.
- ▶ Silicone-based.
- ▶ Long-lasting color.

Packaging: 15L, 7.5 L, 2.5 L, 0.75 L



SUNSHIELD SILFLEX KD

- ▶ Thick textured exterior paint
- ▶ 100% pure acrylic
- ▶ High UV resistance
- ▶ Crack bridging
- ▶ Low dirt retention

Packaging: 15L, 7.5 L, 2.5 L, 0.75 L



SUNSHIELD SILFLEX QU

TS 7847



- ▶ Fine textured exterior paint
- ▶ 100% pure acrylic
- ▶ High UV resistance
- ▶ Crack bridging
- ▶ Low dirt retention

Packaging: 15L, 7.5 L, 2.5 L, 0.75 L



SUNSHIELD SILFLEX DD

TS 7847



- ▶ Orange peel pattern silicone exterior paint
- ▶ 100% pure acrylic
- ▶ High UV resistance
- ▶ Crack bridging
- ▶ Low dirt retention properties
- ▶ High water repellency

Packaging: 15L, 7.5 L, 2.5 L, 0.75 L



AKRITEX LM**TS 7847**

- ▶ Mat.
- ▶ Acrylic based.
- ▶ 1 kg cover 6 m² of surface.
- ▶ Thinned with 10-15% water.

Packaging: 20 Kg, 10 Kg, 3Kg, 1 Kg,**Color Mix****AKRITEX SANDY****TS 7847**

- ▶ Exterior.
- ▶ Medium thickness sand pattern.
- ▶ 3 coats are recommended.
- ▶ 1 kg cover 2 m² of surface; consumption varies depending on the pattern and surface to be applied.

Packaging: 20 Kg, 10 Kg, 3Kg, 1 Kg,**Color Mix****AKRISIL LM****TS 7847**

- ▶ Exterior.
- ▶ Silicone.
- ▶ Matte.
- ▶ Third coat application recommended.
- ▶ 1 kg cover 7 m².
- ▶ Thinned with 10-15% water.

Packaging: 20 Kg, 10 Kg, 3Kg, 1 Kg,**Color Mix****SUPER AKRIMAT****TS 7847**

- ▶ Exterior.
- ▶ Mat.
- ▶ Pure acrylic based.
- ▶ Does not yellow.
- ▶ 1 liters cover 12 m².
- ▶ Thinned with 10-15% water..

Packaging: 15L, 7.5 L, 2.5 L**Color Mix**

AKRILIK SA

TS 7847



- ▶ Pure acrylic-based semi-matte exterior paint.
- ▶ Excellent adhesion to all types of surfaces.
- ▶ Waterproof.
- ▶ 1 liters cover 15 m² .
- ▶ Thinned with 10-15% water.

Packaging: 15L, 7.5 L, 2.5 L,



SILIKOMAT

TS 7847



- ▶ Photocatalytic and silicone-based matte flat paint.
- ▶ New generation silicone additive.
- ▶ Self-cleaning feature.
- ▶ High vapor permeability.
- ▶ Long-lasting.
- ▶ 1 liter cover 12 m².
- ▶ Thinned with 10-15% water.

Packaging: 15L, 7.5 L, 2.5 L, 0.75 L



ASFLEX FLAT

TS 7847



- ▶ Elastomeric exterior flat coating.
- ▶ 100% pure acrylic.
- ▶ Antibacterial.
- ▶ UV resistant.
- ▶ Stretches up to 300% of film thickness.
- ▶ Does not yellow.
- ▶ Crack bridging agent.
- ▶ 1 liters cover 16 m² of surface area.
- ▶ Dilute with 10% water.

Packaging: 20 Kg, 10 Kg, 3Kg, 1 Kg



QUARZ

TS 7847



- ▶ Exterior.
- ▶ Decorative, grainy, fine pattern.
- ▶ Consumption varies depending on the pattern and surface.
- ▶ 3 coat application is recommended.
- ▶ 1 kg cover 2 m² (Consumption varies depending on the pattern and surface to be applied).

Packaging: 20 Kg, 10 Kg, 3Kg, 1 Kg,



QUARZ OD

TS 7847



- ▶ Exterior paint
- ▶ Decorative textured medium pattern
- ▶ Consumption varies depending on pattern and surface
- ▶ 1 kg cover 2 m² (Suitable for normal surfaces)
- ▶ Long lasting
- ▶ Does not yellow
- ▶ UV resistance

Packaging: 20 Kg, 10 Kg, 3Kg



QUARZSIL

TS 7847



- ▶ Silicone-based fine-patterned outer coating.
- ▶ High water repellency.
- ▶ Self-cleaning.
- ▶ Long-lasting.
- ▶ 1 kg cover 2 m² of surface.
- ▶ Dilute with 10-15% water.

Packaging: 20 Kg, 10 Kg, 3Kg



ASFLEX QU

TS 7847



- ▶ Elastomeric fine-patterned coating.
- ▶ 100% pure acrylic.
- ▶ Decorative grainy fine pattern.
- ▶ Stretches up to 300% of film thickness.
- ▶ Does not yellow.
- ▶ Crack bridging.
- ▶ 1 kg cover 8.5 m².
- ▶ Dilute with 10% water.

Packaging: 20 Kg, 10 Kg, 3 Kg, 1 Kg



ASFLEX DD

TS 7847



- ▶ Elastomeric-based thin coating.
- ▶ 100% pure acrylic.
- ▶ Drop pattern.
- ▶ Crack bridging.
- ▶ Dirt-resistant, waterproof.
- ▶ 1 liter cover 7 m².
- ▶ Thinned with 10-15% water.
- ▶ Film thickness stretches up to 300%.

Packaging: 12L, 6 L, 2.5 L, 0.75 L



AKRIKAP

TS 7847



- ▶ Water-based and silicone-based tile paint.
 - ▶ Fade-resistant.
 - ▶ Long-lasting.
 - ▶ UV resistant.
 - ▶ Custom colors can be produced.
 - ▶ 1 kg cover 7.5 m².
 - ▶ Dilute with 10% water.
- ▶ It comes in alternative colors.

Packaging: 15L, 7.5 L, 2.5 L, 0,75 L



SILIKOMAT PRIMER

- ▶ Interior / exterior.
- ▶ It is a special primer that can be applied under silicone-based paints.
- ▶ 1 liters cover 8 m² of surface.
- ▶ It is thinned with 10-20% water.

Packaging: 20 Kg



SUNSHIELD PRIMER 100

- ▶ Solvent-based exterior primer
- ▶ Acrylic copolymer resin
- ▶ Excellent surface penetration properties

Packaging: 15L, 2.5 L, 0,75 L



SUNSHIELD PRIMER 101

- ▶ Water-based exterior alkaline primer
- ▶ Resistant to lime surfaces
- ▶ Excellent surface penetration
- ▶ Acrylic copolymer resin

Packaging: 15L, 2.5 L, 0,75 L



SUNSHIELD PRIMER 102

- ▶ Water-based exterior primer
- ▶ Acrylic copolymer resin
- ▶ Excellent surface penetration

Packaging: 15L, 2.5 L, 0,75 L



NANOSIL PRIMER

- ▶ Prevents salt efflorescence and stains seen in paint.
- ▶ Used on previously painted surfaces.
- ▶ Nanotechnology.
- ▶ Semi-matte.
- ▶ Consumption: 0.40-0.60 lt/m².
- ▶ Ready to use, no dilution required.

Packaging: 15L, 2.5 L, 0,75 L



IZOSIL PRIMER BINDER

- ▶ Water-based alkali-resistant primer.
- ▶ Prevents salt efflorescence and stains in paint.
- ▶ Specially formulated for lime plasters.
- ▶ Used on previously unpainted surfaces.
- ▶ Semi-matte.
- ▶ Consumption: 0.40-0.60 lt/m².
- ▶ Ready to use, no dilution required.

Packaging: 15L, 7.5 L, 2.5 L, 0,75 L



PLASTEX EX COVERING PRIMER

- ▶ Interior/ exterior.
- ▶ Extra white. ▶ Very high coverage.
- ▶ Primer for cement-based surfaces.
- ▶ 1 kg cover 10 m².
- ▶ Dilute with at least 10% and at most 15% water.
- ▶ The surface becomes smooth immediately with special fillers.
- ▶ Can cover black surfaces in a single coat when transitioning from dark to light colors.

Packaging: 20 Kg, 10 Kg, 3Kg, 1 Kg,



TIMEX

- ▶ Interior / exterior facade.
- ▶ Enables painting of cement-based plaster on the same day.
- ▶ 1 liters can prime an area of 4.66 m².
- ▶ Ready to use.

Packaging: 12 L



FOREVER PRIMER

- ▶ Exterior/interior.
- ▶ Solvent-based waterproof exterior primer.
- ▶ 1 liters cover 10 m².
- ▶ Ready to use.

Packaging: 15L. 2.5 L, 0,75 L



MULTIPRIMER

- ▶ High coverage alkali primer
- ▶ Silicone and PURE ACRYLIC
- ▶ Prevents salt efflorescence and stains
- ▶ Specially formulated for liquids containing lime.

Packaging: 15L. 2.5 L, 0,75 L



SIVAAKRIL 100

- ▶ Interior / exterior facade.
- ▶ Acrylic-based thick leveling putty.
- ▶ Can be applied to acrylic painted surfaces.
- ▶ Used for leveling spray surfaces.
- ▶ 2-3 kg of material is required for an area of 1 m².

Packaging: 20 Kg, 10 Kg, 3 Kg, 1 Kg



AKRIATEN EXTERIOR

- ▶ Exterior.
- ▶ Acrylic-based exterior fine leveling putty.
- ▶ Used for leveling and checking on painted surfaces.
- ▶ 1 kg of product cover 2 m² of surface.

Packaging: 20 Kg, 10 Kg, 3 Kg, 1 Kg



AKRISATEN INTERIOR

- ▶ Interior surfaces.
- ▶ Acrylic-based interior surface finishing putty.
- ▶ Can be used over or under paint for finishing and control purposes.
- ▶ 1 kg of product cover 2 m² of surface.

Packaging: 20 Kg, 10 Kg, 3 Kg, 1 Kg



ULTRA CRACKLE PASTE THICK

- ▶ Exterior.
- ▶ Acrylic-based exterior fine leveling putty.
- ▶ Used for leveling and checking on painted surfaces.
- ▶ 1 kg of product cover 2 m² of surface.

Packaging: 20 Kg, 10 Kg, 3 Kg, 1 Kg



ULTRA CRACKLE PASTE FINE

- ▶ Exterior/interior.
- ▶ Solvent-based waterproof exterior primer.
- ▶ 1 liters cover 10 m².
- ▶ Ready to use.

Packaging: 15 L, 7.5 L, 2.5 L, 0,75 L



DR FOREVER

- ▶ It is an impregnation material applied to yellow stones to protect them from water and stains without altering their natural appearance.
- ▶ It makes the applied surface waterproof.
- ▶ 1 kg of product cover 6 m² of surface.
- ▶ Solvent-based.
- ▶ Ready to use.

Packaging: 12 L, 3 L, 0,75 L

UNLEADED 



SILIKOLIT IMPREGNATION

- ▶ It is an impregnation material applied to yellow stones to protect them from water and stains without altering their natural appearance.
- ▶ It makes the applied surface waterproof.
- ▶ 1 kg of product cover 6 m² of surface.
- ▶ Solvent-based.
- ▶ Ready to use.

Packaging: 15 L, 2.5 L, 0,75 L

UNLEADED 



DR.MOLD CLEANER

- ▶ Ideal for preparing moldy areas before painting.
- ▶ A powerful fungicide that cleans and eliminates mold.
- ▶ Completely prevents recurrence in a single application.
- ▶ Cleans, eliminates and protects against mold on all types of surfaces.

Packaging: 20 Kg, 5 Kg, 1 L



MOLD CLEANER

- ▶ Cleans moldy areas before painting.
- ▶ Removes mold.
- ▶ Removes moldy and limescale stains from all types of surfaces.

Packaging: 20 Kg, 5 Kg, 10 Kg, 1 L



ENAMEL GLOSS PAINT

TS 39

- ▶ High coverage.
- ▶ Lasting gloss.
- ▶ Lead-free.
- ▶ Scratch-resistant.
- ▶ 1 liters can paint 15-20 m² of surface.

Packaging: 12 L, 2.5 L, 0,75 L

Colors: White, Black, Ivory, Cream, Golden Yellow, Oxide Yellow, Orange, Flag Red, Gray, Light Gray, Sky Blue, Bead Blue, Navy Blue, Grass Green, Leaf Green, Khaki, Brown, Light Brown

UNLEADED 



ENAMEL MATTE PAINT

TS 39

- ▶ Lead-free.
- ▶ Scratch-resistant.
- ▶ Matte finish.
- ▶ 1 liter can paint 12-16 m² of surface.

Packaging: 12 L, 2.5 L, 0,75 L

Colors: Matte Black, Semi-Matte Black, Matte White

UNLEADED 



SYNTHETIC PRIMER

- ▶ Leaves no brush marks.
- ▶ Adheres well to the surface.
- ▶ 1 liter can prime 12-15 m² of surface.

Packaging: 12 L, 2.5 L, 0,75 L

Colors: Bright White

UNLEADED 



ANTI-RUST SOLUTION

- ▶ It is a rust inhibitor.
- ▶ It dries quickly.
- ▶ 1 liters can paint 7-9 m² of surface.

Packaging: 12 L, 2.5 L, 0,75 L

Colors: Gray, Red

UNLEADED 





ASTEX DECORATIVE WOOD PROTECTOR

- ▶ 6X protection.
- ▶ Protection against moisture, blueness, rot, mold, algae and insects.
- ▶ UV protection.
- ▶ 1 liters can paint 5-13 m² of surface.

Packaging: 12 L, 2.5 L, 0,75 L

UNLEADED 

Colors: Colorless 720, Light Oak 721, Teak 724, Dark Oak 726, Ebony 728, Mahogany 731, Walnut 732, Antique Oak 733, Chestnut 735, Natural Oak 734, Cherry 736, Rosewood 737



GLASS POLISH VARNISH

- ▶ High gloss.
- ▶ Scratch-resistant.
- ▶ 10-15 m² of surface can be painted with 1 liters.

Ambalaj: 12 L, 2.5 L, 0,75 L

Colors: Shiny

UNLEADED 



YACHT VARNISH

- ▶ High gloss.
- ▶ Scratch-resistant.
- ▶ UV resistant.
- ▶ 1 liters can paint 12-16 m² of surface.

Packaging: 12 L, 2.5 L, 0,75 L

Colors: Shiny

UNLEADED 



SILVATEKS

- ▶ Solvent-based polished decorative wood protector
- ▶ Protection power increased by 6X
- ▶ Protects wood against mold, bacteria, fungi, blue discoloration, rot, moss and insects
- ▶ UV resistant
- ▶ 1 L can cover 5-13 m² of surface

Packaging: 12 L, 2.5 L, 0,75 L

Colors: Natural Oak 720

UNLEADED 



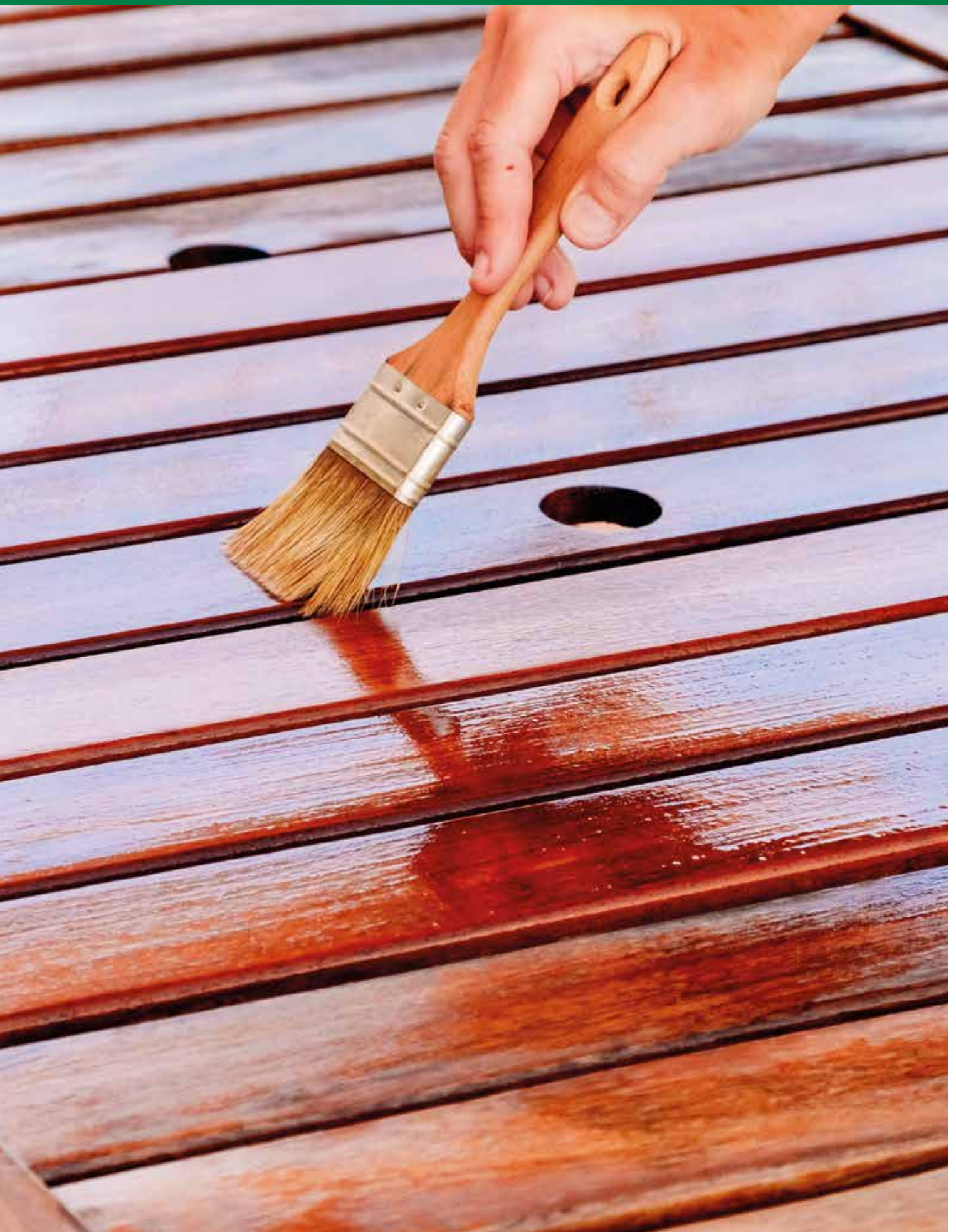

RAPID INDUSTRIAL TOPCOAT PAINT

- ▶ Air-drying, styrene-modified alkyd-based.
- ▶ Provides very fast surface drying.
- ▶ Scratch-resistant.
- ▶ When applied in a single coat to leave a dry film thickness of 40-45 μ , 1 liter can cover
- ▶ 10-12 m² (excluding losses).
- ▶ Please inquire about current prices for other colors.

Packaging: 12 L, 2.5 L, 0,75 L

Colors: White, Matte Black, Glossy Black

UNLEADED 



RAPID INDUSTRIAL ANTI-RUST PRIMER

- ▶ It is anti-rust.
- ▶ Dries in 10-8 minutes.
- ▶ Complies with TS 11651.
- ▶ When applied to leave a dry film thickness of 30-35 μ in a single coat, 1 liter can cover an area of 10-12 m². (Excluding losses)

Packaging: 12 L, 2.5 L, 0,75 L

Colors: Gray, Red

UNLEADED 



RUSTGUARD

- ▶ Contains special German-made anti-corrosion raw materials.
- ▶ 3X more rust-preventive than normal anti-rust primers.
- ▶ When applied to leave a dry film thickness of 30 μ in a single coat, 1 liter cover 6-8 m

Packaging: 112 L, 2.5 L, 0,75 L

Colors: Yellow

UNLEADED 





CELLULOSIC THINNER

- ▶ It is a thinner for cellulosic paints and primers.
- ▶ It is used for cleaning all types of paint tools.

Packaging: 12 L, 2,5 L, 0,75 L



SYNTHETIC THINNER

- ▶ It is a thinner for synthetic paints and primers.
- ▶ It is used for cleaning all types of paint tools.

Packaging: 12 L, 2,5 L, 1 L, 0,60 L, 0,30 L



RAPID THINNER

- ▶ Used to thin rapid paints.
- ▶ Has high dissolving power.
- ▶ Used for cleaning all types of paint tools.

Packaging: 12 L, 2,5 L, 1 L



DR. FOREVER THINNER

- ▶ It is a lead-free, odorless thinner.
- ▶ It has high dissolving power.
- ▶ It is used for cleaning all types of paint tools.

Packaging: 12 L, 2,5 L, 1 L



STONE CARPET PU THINNER

Equipment cleaning solvent for Stone Carpet applications is a volatile, flammable, and solvent-like chemical used to clean equipment such as trowels, brushes, and rollers used after application.

NOTE: DO NOT ADD TO STONE CARPET PRODUCT.FOR CLEANING ONLY.

Packaging: 12 L, 2.5 L, 1 L



WASH THINNER (CLEANING THINNER)

Wash Thinner is a mixture of fast-evaporating solvents used to clean oils and solvents from tools and equipment. It is used to clean spray equipment and tools. It is recommended for cleaning contact adhesive. It should not be diluted.

Packaging: 12 L, 2.5 L, 0,75 L



RAPID SOLVENT HAND APPLICATION

Suitable for hand application in rapid products, this is an application thinner that adjusts the fluidity.

Packaging: 12 L, 2.5 L, 1 L





CONSTRUCTION CHEMICALS GROUP

- ▶ ADHESIVE MORTARS
- ▶ GROUT FILLING PRODUCTS
- ▶ CEMENT-BASED PLASTERS
- ▶ GLOSSY SURFACE PLASTERS
- ▶ GYPSUM BOARD PLASTERS
- ▶ THERMAL INSULATION
- ▶ PRIMERS
- ▶ GYPSUM AND SPRAY PRODUCTS
- ▶ MORTAR ADDITIVES
- ▶ WATERPROOFING PRODUCTS

SERFLEX PLUS

C2TES2

- ▶ Indoors and outdoors
- ▶ Tiles and ceramics
- ▶ Horizontal and vertical surfaces
- ▶ Heated floors
- ▶ Cold storage facilities
- ▶ Long processing time
- ▶ 3.5 kg per 1 m²
- ▶ EN 12004-1: 2017 C2TES2

Packaging: 20 Kg
Color: White, Gray



SERFLEX MORTAR 1

C2TES1

LARGE SIZE TILE AND CERAMIC GRANITE ADHESIVE

- ▶ Indoors and outdoors
- ▶ On horizontal and vertical surfaces
- ▶ Large-sized tiles, ceramics and granite
- ▶ Heated floors
- ▶ Cold storage facilities
- ▶ Long processing time
- ▶ 3.5 kg per 1 m²
- ▶ EN 12004-1: 2017 C2TES1

Packaging: 20 Kg
Color: White, Gray



SERFLEX 200 H

C2TES1

ADHESIVE FOR SWIMMING POOLS AND WATER TANKS

- ▶ Used indoors and outdoors
- ▶ On horizontal and vertical surfaces
- ▶ Swimming pools
- ▶ Water tanks
- ▶ Long processing time
- ▶ 3.5 kg per 1 m²
- ▶ EN 12004-1: 2017 C2TES1

Application surfaces:

- ▶ Swimming pools
- ▶ Water tanks

Packaging: 20 Kg
Color: White, Gray



SERFLEX

C2TE

CEMENT-BASED TILE AND CERAMIC ADHESIVE

- ▶ Used indoors and outdoors
- ▶ Tiles and ceramics
- ▶ On vertical and horizontal surfaces
- ▶ 3.5 kg is used per 1 m²
- ▶ EN 12004-1: 2017 C2TE

Packaging: 20 Kg
Color: White, Gray



SERFLEX 100 N

C2TE

CEMENT-BASED TILE AND CERAMIC ADHESIVE

- ▶ Used indoors and outdoors
- ▶ On horizontal and vertical surfaces
- ▶ Processing time is long
- ▶ Tiles and ceramics
- ▶ 3.5 kg for 1 m²
- ▶ EN 12004-1: 2017 C2TE

Packaging: 20 Kg

Color: White, Gray



SERFLEX FAYSER 2000

C1TE

CEMENT-BASED TILE AND CERAMIC ADHESIVE

- ▶ Used indoors
- ▶ On horizontal surfaces
- ▶ Ceramic
- ▶ 3.5 kg for 1 m²
- ▶ EN 12004-1: 2017 C1TE
- ▶ Processing time is long.
- ▶ 3.5 kg per 1 m²

Packaging: 20 Kg

Color: White, Gray



BED FABRIC

EN 998-2: 2016

AERATED CONCRETE BED MORTAR

- ▶ It is the mortar used when laying aerated concrete on the ground.
- ▶ It is used to separate the aerated concrete from the concrete surface.
- ▶ It prevents the aerated concrete from cracking as a result of movements in the reinforced concrete.

- ▶ EN 998-2: 2016

Packaging: 20 Kg

Color: Gray



AERATED CONCRETE ADHESIVE

EN 998-2: 2016

AERATED CONCRETE ADHESIVE

- ▶ Aerated concrete adhesive
- ▶ EN 998-2: 2016

Packaging: 25 Kg

Color: Gray



ELASTOFLEKS

- ▶ For bonding large-sized ceramics and granite
- ▶ For bonding ceramics on industrial floors
- ▶ Used in water tanks and swimming pools
- ▶ 0.28 kg per 1 m²

Packaging: 20 Kg, 5 Kg, 1 Kg



DERZDOSİL

CG-2WA

SILICONE GROUT FOR CERAMICS AND TILES

- ▶ Ready-made colored silicone-added grout
- ▶ See consumption section for consumption information
- ▶ EN 13888 CG-2WA

Packaging: 20 Kg, 5 Kg, 2 Kg, 1 Kg

Color: White, Grey, Milk Coffee, Champagne, Sand Beige, Light Grey, Beige, Cream, Brown, Dark Grey, Black, Anthracite



DERZDOLEX

CG-2A

GROUT FOR CERAMICS AND TILES

- ▶ It is a decorative grout material for ceramic and tile joints.
- ▶ See the consumption section for consumption information.
- ▶ EN 13888 CG-2A

Packaging: 20 Kg

Color: White, Grey



GROUT CLEANER

TILE AND CERAMIC GROUT CLEANER

- ▶ For walls and floors indoors and outdoors
- ▶ It is an industrial product
- ▶ Developed for tile and ceramic surfaces
- ▶ Suitable for cleaning dirt and stains on surfaces in areas such as bathrooms, pools, kitchens and terraces
- ▶ Cleans plaster, grout and paint residues after construction

Packaging: 20 Kg, 10 Kg, 5 Kg, 1 L, 500 ml



SIVATEKS 15

GP,CSIII,W0

CEMENT-BASED, LIME-FREE, SECOND-COAT PLASTER

- ▶ For interior and exterior surfaces
- ▶ Third coat plaster
- ▶ Lime-free product
- ▶ Fiber-reinforced
- ▶ Finished with a steel trowel
- ▶ Resistant to moisture and humidity
- ▶ Creates a smooth and hard surface
- ▶ kg for 1 m²
- ▶ EN 998-1: 2016 GP,CSIII,W0

Packaging: 20 Kg

Color: White



SIVAKS

GP,CSIII,W1

CEMENT AND LIME-BASED THIRD-COAT PLASTER

- ▶ For exterior surfaces
- ▶ Third coat plaster
- ▶ Fiber reinforced
- ▶ Finished with sponge
- ▶ Creates a smooth and hard surface
- ▶ kg for 1 m²
- ▶ EN 998-1: 2016 GP,CSIII,W1

Packaging: 20 Kg

Color: White, Grey



EUROPLAS

GP,CSIII,W1

CEMENT, 100% SILICONE AND FIBER REINFORCED THIRD-COAT PLASTER

- ▶ For exterior surfaces
- ▶ Third coat plaster
- ▶ Silicone additive
- ▶ Finished with sponge
- ▶ Easily leveled and smoothed
- ▶ Resistant to moisture and humidity
- ▶ kg for 1 m²
- ▶ EN 998-1: 2016 GP,CSIII,W1

Packaging: 35 Kg, 20 Kg

Color: White, Grey



EUROPLAS KD 208

GP,CSIII,W1

THICK FILLER THIRD-COAT PLASTER WITH CEMENT SILICONE, AND FIBER REINFORCEMENTS

- ▶ For exterior surfaces
- ▶ Third coat plaster
- ▶ Silicone additive
- ▶ Finished with sponge
- ▶ Fiber reinforced
- ▶ Does not show shrinkage cracks
- ▶ 4-5 kg for 1 m²
- ▶ EN 998-1: 2016 GP,CSIII,W1

Packaging: 35 Kg **Color:** White, Grey



EUROSİL

GP,CSIII,WI

CEMENT, 100% SILICONE AND FIBER REINFORCED THIRD-COAT PLASTER

- ▶ For exterior surfaces
- ▶ Third coat plaster
- ▶ 100% silicone additive
- ▶ Finished with sponge
- ▶ Easily leveled and smoothed
- ▶ Resistant to moisture and humidity
- ▶ kg for 1 m²
- ▶ EN 998-1: 2016 GP,CSIII,W1

Packaging: 20 Kg

Color: White



ASTECO INTERIOR

GP,CSII,W0

CEMENT-BASED THIRD-COAT INTERIOR WALL PLASTER

- ▶ For interior surfaces
- ▶ Third coat plaster
- ▶ Finished with sponge
- ▶ Final sponge application is done quickly
- ▶ It creates a smooth and hard surface.
- ▶ 1 m² için 4 kg
- ▶ EN 998-1: 2016 GP,CSII,W0

Packaging: 25 Kg

Color: Grey



ASTECO EXTERIOR

GP,CSIII,WI

CEMENT, 100% SILICONE AND FIBER REINFORCED THIRD-COAT PLASTER

- ▶ For exterior surfaces
- ▶ Waterproof
- ▶ Hand-plastered
- ▶ Fiber-reinforced
- ▶ Finished with sponge
- ▶ Final layer sponge application done quickly
- ▶ kg for 1 m²
- ▶ EN 998-1: 2016 GP, CSIII, W

Packaging: 25 Kg

Color: Grey



SATENTEKS 5

GP,CSIII,W0

CEMENT-BASED SATIN FINISHING PLASTER

- ▶ For interior and exterior surfaces
- ▶ Satin finish
- ▶ Super White
- ▶ Lime-free product
- ▶ Finished with steel trowel
- ▶ Resistant to moisture and humidity
- ▶ 1.33 kg for 1 m²
- ▶ EN 998-1: 2016 GP,CSIII,W0

Packaging: 20 Kg, 5 Kg

Color: White



THIN PLASTER

GP,CSIII,WI

FINE PLASTER OVER ROUGH PLASTER

- ▶ Used indoors and outdoors
- ▶ Finished with sponge
- ▶ Short processing time
- ▶ Minimum 4mm thickness must be applied
- ▶ 4-4.5 kg for 1 m²
- ▶ EN998-1: 2016 GP,CSIII,WI



Packaging: 35 Kg
Color: White, Grey

ELMATİK E-100

GP,CSIV,W1

CEMENT-BASED COARSE PLASTER

- ▶ For interior and exterior surfaces
- ▶ Lime-free product.
- ▶ Rough plaster on brick, block and BMS surfaces.
- ▶ Easier to apply a level compared to classic rough plaster
- ▶ 15 kg per 1 cm in 1 m²
- ▶ EN998-1: 2016 GP,CSIV,W1



Mix it



Packaging: 25 Kg
Color: Grey

SAND AND CEMENT

✓ PROCESSABILITY
NO ADDITIVES

Cement & Sand is a ready-mixed mortar made from a mixture of cement and sand, offering practical use in repair and filling work. It is easy and quick to use; it is a reliable choice for various construction applications. It can be used for filling under ceramic and marble, plastering, and wall construction. It can be applied with appropriate workability additives as needed. Adhesion performance and working time can be increased with the correct use of additives.

Packaging: 25 Kg



MARBLE AND CERAMIC UNDERGROUND FILLING



REPAIR WORKS



BRICK BUILDING



SERPMEMİX E 100

GP,CSIII,W0

CEMENT-BASED SPRAY PLASTER

- ▶ For interior and exterior surfaces
- ▶ It is a sprayed plaster that can be applied by hand
- ▶ Suitable for brick, pumice and block.
- ▶ 5-8 kg per 1 m²
- ▶ EN 998-1: 2016 GP,CSIII,W0



Packaging: 25 Kg
Color: Grey



YAPSER 5

GP,CSIV,W0

CEMENT-BASED GLOSS SURFACE PLASTER

- ▶ For interior and exterior surfaces
 - ▶ Final coat plaster
 - ▶ Super white
 - ▶ Finished white steel trowel
 - ▶ 2.85 kg is used for 1 m² (0.5 mm thickness)
- ▶ EN 998-1: 2016 GP, CSIV,W0
 - ▶ It ensures that the surfaces to be painted after the repair of concrete structures are smoother and more even.

Packaging: 20 Kg,5 Kg
Color: White



YAPSER 10

GP,CSIV,W0

CEMENT-BASED GLOSS SURFACE PLASTER

- ▶ For interior and exterior surfaces
- ▶ Applied to raw concrete and glossy surfaces
- ▶ Can be applied without primer on glossy surfaces
- ▶ Finished with a steel trowel
- ▶ Allows application up to 48 mm
- ▶ EN 998-1: 2016 GP,CSIV,W0

Packaging: 20 Kg
Color: White



YAPSER 15

GP,CSIII,W1

CEMENT-BASED GLOSS SURFACE PLASTER

- ▶ For interior and exterior surfaces
- ▶ Applied to raw concrete and glossy surfaces
- ▶ Can be applied without primer on glossy surfaces
- ▶ Finished with steel trowel
- ▶ Fiber reinforced
- ▶ Suitable for application between 45-10 mm
- ▶ EN 998-1: 2016 GP,CSIII,W1

Packaging: 20 Kg
Color: White, Grey



YAPSER 20

GP,CSIV,W1

CEMENT-BASED GLOSS SURFACE PLASTER

- ▶ For interior and exterior surfaces
- ▶ Can be used as rough plaster and repair mortar on raw concrete and glossy surfaces
- ▶ Can be applied without primer on glossy surfaces
- ▶ Finished with a steel trowel
- ▶ Fiber reinforced
- ▶ Suitable for application between 1.5-5 cm
- ▶ EN 998-1: 2016 GP,CSIV,W1

Packaging: 20 Kg
Color: Grey





SUPERPLAST FIRST

GP,CSIII,W1

BORDEX SURFACE LEVELING PLASTER

- ▶ For interior and exterior surfaces
- ▶ Flexible plaster suitable for gypsum board, boardex and fiber cement board
- ▶ Suitable for surface leveling and filling.
- ▶ EN 998-1: 2016 GP,CSIII,W1
- ▶ Applied and finished with a steel trowel
- ▶ The surface must be finished with Superplast Finish
- ▶ Does not form cracks thanks to special polymer additives
- ▶ 7kg/m² in mesh applications, 5kg/m² in non-mesh applications



Packaging: 20 Kg **Color:** Grey

SUPERPLAST FINISH

GP,CSIII,W1

BORDEX THIRD COAT PLASTER

- ▶ For interior and exterior surfaces
- ▶ Flexible plaster suitable for gypsum board, bordex and fiber cement board
- ▶ Trifil, third coat surface suitable for foaming
- ▶ Applied with steel trowel, finished with foam
- ▶ EN 998-1: 2016 GP,CSIII,W1
- ▶ For surfaces that need filling, Superplast First should be applied to the surface first.
- ▶ Thanks to special polymer additives, it does not create cracks.
- ▶ 2.9kg/m²



Packaging: 20 Kg
Color: Grey

SUPER PAN THIN

GYP SUM BOARD AND BORDEX SATIN PUTTY

- ▶ Suitable for interior and exterior surfaces
- ▶ Developed for use on gypsum board and Bordex type panels
- ▶ It is a finishing material, an equivalent to satin plaster.
- ▶ It is very flexible to prevent cracking
- ▶ Unlike satin plaster, it has a dust-free surface
- ▶ It is applied and finished with a steel trowel
- ▶ Not suitable for foaming
- ▶ It is cement-based, not affected by moisture like plaster
- ▶ Can be painted over without requiring a primer
- ▶ Consumption is 1.33 kg per 1 m²
- ▶ EN 998-1: 2016



Packaging: 30 Kg, 5 Kg
Color: White

SUPER PAN MIDDLE

GYPSUM BOARD AND BOARDX FILLER

- ▶ Suitable for interior and exterior surfaces
- ▶ Developed for use on gypsum boards and Bordex type panels
- ▶ Cement-based, not affected by moisture like gypsum
- ▶ Used for leveling the surface and closing joint gaps.
- ▶ It is an alternative to plaster
- ▶ Not suitable for foaming
- ▶ Very flexible to prevent cracking in joints
- ▶ Applied and finished with a steel trowel
- ▶ Consumption is 3.3 kg per 1 m²
- ▶ EN 998-1: 2016

Packaging: 20 Kg, 5 Kg

Color: White



SERFLEXTHERM 2001 15

GP,CSIV,W1

COARSE ADHESIVE FOR EPS, XPS, AND ROCK WOOL

- ▶ It is an adhesive for EPS, XPS and rock wool boards.
- ▶ It does not slip in vertical applications.
- ▶ It has a long processing time.
- ▶ It has high bonding properties.
- ▶ 4.5 kg per m²
- ▶ EN 998-1: 2016 GP,CSIV,W1

Packaging: 20 Kg
Color: Grey, White



SIVATHERM 15 EPS-100

GP,CSII,W1

EPS THERMAL INSULATION BOARD PLASTER

- ▶ EPS is a thermal insulation plaster for 4EPS boards.
- ▶ Fiber reinforced. Does not crack on EPS boards.
- ▶ Not suitable for XPS boards.
- ▶ Finished with a steel trowel.
- ▶ 5 kg per 1 m²
- ▶ EN 998-1: 2016 GP,CSII,W1

Packaging: 20 Kg
Color: Grey



SIVATHERM ZERO

GP,CSII,WI

SPONGE FINISHABLE INSULATION PLASTER

- ▶ For exterior surfaces
- ▶ Sponge-finishable topcoat plaster for insulated surfaces
- ▶ Does not crack thanks to polymer additives
- ▶ Fiber reinforced
- ▶ 100% waterproof

Packaging: 20 Kg

Color: Grey

- ▶ Final finish achieved with a sponge trowel
- ▶ 2.85 kg is used for 1 m²
- ▶ EN 998-1: 2016 GP,CSII,W1



CIMEXTHERM DECOPUTZ - MINERAL

GP,CSII,W0

THERMAL INSULATION DECORATIVE PLASTER - MINERAL

- ▶ For exterior facades
- ▶ It is the final decorative plaster for insulated surfaces
- ▶ It is the final decorative plaster for Bordex and ABS extreme exterior facade plasterboards
- ▶ Does not crack thanks to polymer additives
- ▶ Fiber reinforced
- ▶ 100% waterproof
- ▶ Applied with steel trowel, finished with plastic trowel
- ▶ .5 kg is used per 1 m²
- ▶ EN 998-1: 2016 GP,CSII,W0

Packaging: 25 Kg

Thickness: 1,5 mm, 2 mm, 3 mm



Vertical Line



Horizontal Line



Oval



SIVATHERM 2000

**CARBON
THERMAL
INSULATION
SYSTEM**

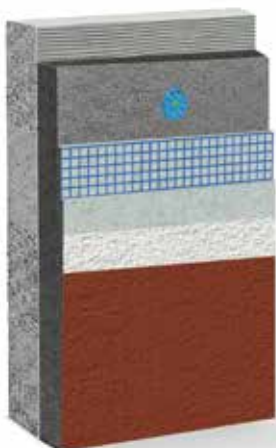

**XPS
THERMAL
INSULATION
SYSTEM**



**ROCK WOOL
THERMAL
INSULATION
SYSTEM**



CIMEXTHERM DECOPUTZ - LINE
GP,CSII,W0

THERMAL INSULATION DECORATIVE PLASTER

- ▶ For exterior facades
- ▶ It is the final decorative plaster for insulated surfaces
- ▶ It is the final decorative plaster for Bordex and ABS extreme exterior facade plasterboards
- ▶ Does not crack thanks to polymer additives
- ▶ Fiber reinforced
- ▶ 100% waterproof
- ▶ Applied with steel trowel, finished with plastic trowel
- ▶ 2.5 kg is used per 1 m²
- ▶ EN 998-1: 2016 GP,CSII,W0

Packaging: 20 Kg
Thickness: 2 mm, 3 mm

ASLAN DECORATIVE COATING TEXTURES

1 mm Decorative Coating

1.5 mm Decorative Coating

2 mm Decorative Coating

2 mm Line Texture Decorative Coating

2 mm Oval Line Texture Decorative Coating

3 mm Line Texture Decorative Coating

3 mm Round Line Texture Decorative Coating

PLASTER INSULATION MESH

INSULATION MESH

- ▶ Used in exterior and interior thermal insulation cladding systems.
- ▶ 100cm x 50mt

Thickness: 160 gr

Color: Blue



CARBONATED EPS BOARD

INSULATION BOARD

- ▶ Provides high insulation
- ▶ Easy to apply
- ▶ Provides an economical system

Dimension: 50x100x3 cm, 50x100x5 cm

Density:16

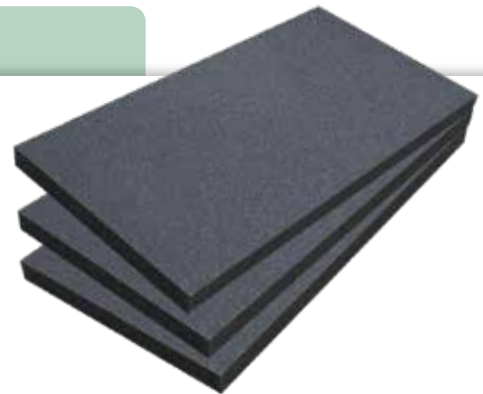

MESH INSULATION CORNER

INSULATION CORNER

- ▶ For building exterior and interior corners
- ▶ Used at window centers
- ▶ Ensures verticality at wall corners and increases resistance to impacts.

Thickness:160 gr

Size:2.5 m

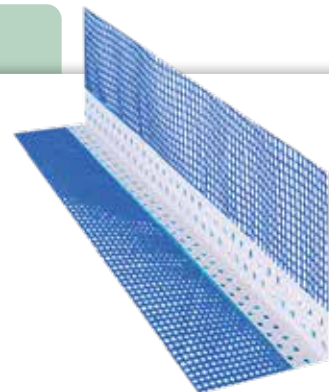

THERMAL INSULATION DOWEL

- ▶ Provides high application safety
- ▶ Simple and quick assembly with a hammer
- ▶ Provides high load-bearing capacity in soft building materials
- ▶ Used for fixing thermal insulation boards to building facades
- ▶ More durable with reinforced cross-section and increased strength

Length: 10 cm, 12 cm



ASLAN SIVATHERM 2000 SYSTEM COMPONENTS

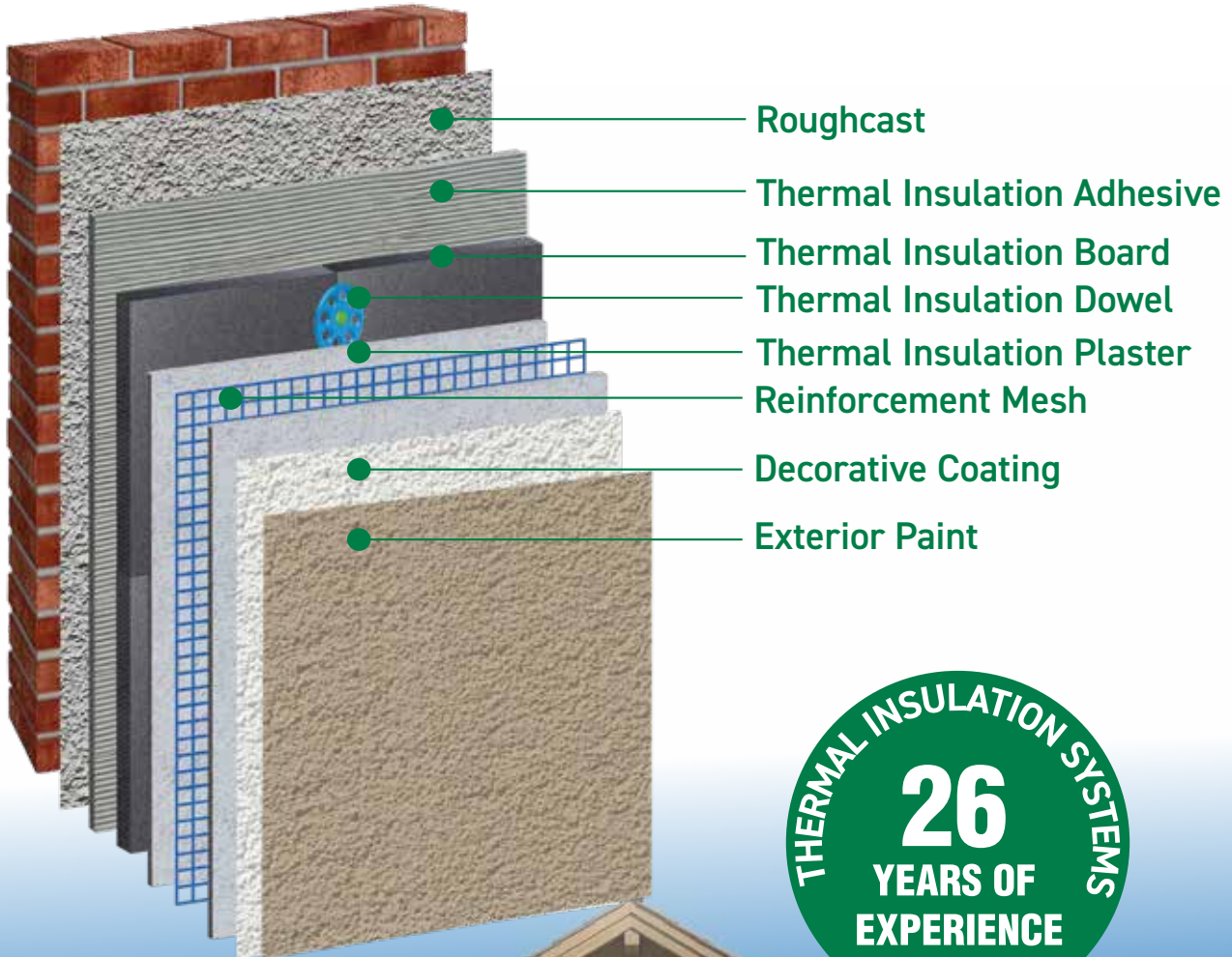

THERMAL INSULATION SYSTEMS
26
YEARS OF
EXPERIENCE



**ASLAN THERMAL INSULATION SYSTEM
PRODUCTS FOR YOUR FACADES**

MAXIMUM PROTECTION



GIPSOPLAS

RAW CONCRETE PRIMER

- ▶ Ensures that gypsum and cement-based plasters adhere to a glossy surface.
- ▶ Excellently increases adhesion.
- ▶ When diluted, it cover an area of 210-375 g/m².

Packaging: 12 Kg ,6 Kg, 2 Kg

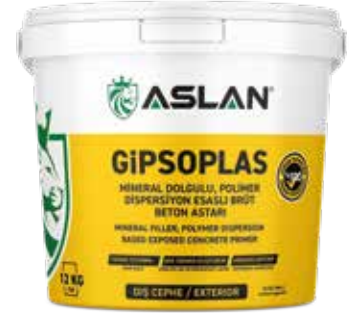

ANTICOAT W CORROSION PRIMER

CORROSION-PROOF PRIMER

- ▶ Cement-based
- ▶ Corrosion-preventive primer
- ▶ Used for priming rusted reinforcing steel
- ▶ Applied with a wedge brush
- ▶ Application thickness should be at least 1-1.5 mm and at least two coats should be applied
- ▶ 1.5-2 kg / 1 m² depending on the absorbency of the surface

Packaging: 20 Kg, 10 Kg, 3 Kg, 1 Kg



FOREVER PRIMER

SOLVENT-BASED MULTI-PURPOSE PRIMER

- ▶ For exterior and interior surfaces
- ▶ Solvent-based waterproof primer
- ▶ Produced for cigarette smoke stains and fire-damaged surfaces
- ▶ 1 liter cover 10 m²
- ▶ Ready to use

Packaging: 15 L, 2.5 L, 0,75 L



PRIMER WET 250

SPECIAL DISPERSION-BASED

- ▶ Special dispersion-based
- ▶ High adhesion properties
- ▶ Single-component wet-in-wet application special primer that strengthens bond strength.
- ▶ It is a primer applied before Antik Wall application.

Packaging: 20 Kg, 10 Kg, 3 Kg, 1 Kg



PRIMER PY 555

SMOOTH GLOSSY SURFACE PRIMER

- ▶ Acrylic dispersion based
- ▶ Adhesion enhancing primer
- ▶ Ready to use
- ▶ Easy and quick application
- ▶ Not suitable for application on gypsum plaster, gypsum board or gypsum blocks
- ▶ Supports surface strength in ceramic-on-ceramic bonding
- ▶ Consumption 300-350 gr/m²

Packaging: 15 Kg, 7.5 Kg, 3 Kg, 1 Kg



CON POWDER

MICRONIZED SPIRIT POWDER

- ▶ Micronized Spirit Powder
- ▶ Micronized Marble Powder

Packaging: 20 Kg

Thickness: Coarse, Fine, Micronized Marble Powder



PLASTER

CONSTRUCTION PLASTER

- ▶ Fast-drying construction plaster

Packaging: 10 Kg



REPAMIX 200

R2 CLASS

CEMENT BASED THICK REPAIR MORTAR

- ▶ Used indoors and outdoors
- ▶ Used in the repair of concrete structures
- ▶ Does not shrink
- ▶ Used in the chamfering of swimming pools and water tanks
- ▶ Can be applied up to 3 cm thickness
- ▶ Classified as R2 mortar for concrete repairs according to EN 1504-3.

Packaging: 20 Kg **Color:** Grey



REPAMIX 300

R3 CLASS

HIGH-PERFORMANCE, CEMENT-BASED SHRINKAGE-FREE STRUCTURAL REPAIR MORTAR

- ▶ Easy to apply, shrinkage-free, flexible structure.
- ▶ Does not sag or shrink.
- ▶ Provides high adhesion to concrete.
- ▶ Sets quickly and does not crack.
- ▶ Applied horizontally and vertically in indoor and outdoor areas (in a single coat).
- ▶ Allows application up to 3 cm.
- ▶ Reinforced with polymer and fiber. Classified as R3 mortar for concrete repairs according to EN 1504-3.

Packaging: 25 Kg **Color:** Grey



REPAMIX TA

THREAD AND CORE HOLE REPAIR MORTAR

- ▶ Repair mortar for tie rod holes and core voids in concrete surfaces
- ▶ Does not sag or shrink
- ▶ Can be applied in thicknesses between 0.5 cm and 2 cm
- ▶ Sets quickly and does not crack
- ▶ 14 kg per 1 cm in 1 m²

Packaging: 25 Kg **Color:** Grey



GROUT FLOW-100

SELF-CLASSIFYING GROUT MIX

- ▶ It is a cement-based self-leveling grout mortar.
- ▶ For fixing steel columns to the foundation
- ▶ For machine and crane assembly
- ▶ Can be applied in thicknesses between 10-80 mm
- ▶ 19 kg per 1 m² for 10 mm

Packaging: 25 Kg **Color:** Grey



WATER PLUG

ASPLUG

- ▶ Micronized chemical powder for waterproofing
- ▶ Applied in powder form without mixing with water
- ▶ Provides waterproofing by freezing in 2-3 seconds upon contact with water
- ▶ Consumption 2 Kg/L
- ▶ Ensures the rapid stopping of water seeping through cracks and gaps and coming under pressure
- ▶ Use gloves during application

Packaging: 20 Kg, 10 Kg, 2 Kg, 1 Kg



LATEKS 555

ADDITIVE FOR ACRYLIC-BASED PLASTERS AND SCREEDS

- ▶ It is an adhesion and waterproofing additive for plasters and screeds.
- ▶ It reduces cracks by increasing the tensile strength in bending in plasters.
- ▶ 0.400 kg is used in cement.

Packaging: 20 Kg, 5 Kg, 1 Kg



NANOPLAS PM 200

PLASTER WORKABILITY ADDITIVE

- ▶ Plaster workability additive
- ▶ Extended setting time
- ▶ Easy troweling
- ▶ Reduces shrinkage cracks
- ▶ White color
- ▶ 0.15-0.250 gr is used for 50 kg of cement

Packaging: 20 Kg, 5 Kg, 1 Kg, 0,250 Kg



LIME WATER NANOPLAS MM100

PLASTER AND SCREED ADDITIVE

- ▶ Plaster workability additive
- ▶ Normal setting area
- ▶ Brown
- ▶ 0.15-0.250 gr is used for 50 kg of cement

Packaging: 20 Kg, 5 Kg



ASBOND SBR BONDİNG

PLASTER AND SCREED ADDITIVE

- ▶ 1. Styrene butadiene-based very strong plaster and screed additive for better adhesion of plaster to the surface. Specially formulated for adhesion of classic rough plaster to concrete in columns, beams and ceilings.

- ▶ See TDS for mixing ratio.

Packaging: 20 Kg, 5 Kg, 1 Kg



FLEXCOAT PRO HYBRID Acrylic + PU Liquid Insulation

ADDITIVE FOR ACRYLIC-BASED PLASTERS AND SCREEDS

- ▶ It has high UV resistance.
- ▶ It has high elasticity.
- ▶ IT NEVER DISSOLVES IN WATER DURING THE LIFESPAN OF THE INSULATION.
- ▶ It is a hybrid product, based on acrylic and polyurethane resin.
- ▶ The final lifespan of the product under the sun is directly proportional to the application thickness.
- ▶ For a lifespan of more than 5 years and/or for the application to be considered within the scope of the factory warranty,
- ▶ ASLAN FOREVER PRIMER must have been used as an insulation primer.
- ▶ For the factory warranty to be given,
- ▶ Flexcoat Pro Hybrid must have been applied at least 1.5 kg/m².

Packaging: 15 L, 7.5 L, 2.5 L.



LIQUID MEMBRANE

HIGH UV RESISTANT LIQUID INSULATION

- ▶ High UV resistance. ▶ High elasticity.
- ▶ Ready-to-use waterproofing product.
- ▶ The application thickness is directly proportional to the product's ultimate lifespan under the sun.
- ▶ For a lifespan of more than 5 years and/or for the application to be considered within the scope of the factory warranty, at least 1.5 kg/m² of application is required.
- ▶ Complies with EN 14891-2017 Standard.

Packaging: 20 Kg, 10 Kg, 3 Kg, 1 Kg



LIQUID MEMBRANE FIBER

A single-component, ready-to-use waterproofing material based on polymer and reinforced with polypropylene microfibers, used in precast gutters for terrace roofs and exterior facades.

- ▶ Complies with EN 14891-2017 Standard.

Packaging: 20 Kg, 10 Kg, 3 Kg, 1 Kg



CRYSTAL

CRYSTALLIZED WATERPROOFING CONCRETE ADDITIVE

This is a new generation waterproofing additive that, by reacting with moisture in the concrete, forms an insoluble crystalline structure within the capillary cracks and pores of the concrete, making the concrete waterproof.

Packaging: 20 Kg, 5 Kg, 1Kg, 1000 Kg IBC



IZOFLEX MEMBRANE

LIQUID INSULATION

- ▶ Fully elastic.
- ▶ Ready-to-use waterproofing product.
- ▶ The application thickness is directly proportional to the product's ultimate lifespan under the sun.
- ▶ For a lifespan of over 3 years and/or for the application to be considered within the scope of the factory warranty, at least 1.5 kg/m² of application is required.

Packaging: 20 Kg, 10 Kg, 3 Kg



TERAFLEKS 2K UV FULLY FLEXIBLE

CM 02P

DOUBLE MIX INSULATION

- ▶ Cement and acrylic based, two-component, fully flexible insulation material.
- ▶ UV resistant.
- ▶ Water vapor permeable.
- ▶ Protects concrete against carbonation.
- ▶ Resistant to underground chemicals and salt solutions.
- ▶ Resistant to freezing and thawing.
- ▶ Can be used in areas affected by vibration due to its elastic structure.
- ▶ 20 kg powder to 10 kg liquid.
- ▶ Water should not be added to the mixture.
- ▶ Fiber reinforced.
- ▶ 3-3.50 kg/m² for 2mm application.
- ▶ Complies with EN 14891: 2017 Standard.

Packaging: 20 Kg Powder, 10 Kg Liquid, 30 Kg Set



TERAFLEKS 2K-105 SEMI-ELASTIC

DOUBLE MIX INSULATION

- ▶ Cement and acrylic based, two-component, semi-flexible insulation material
- ▶ For vertical and horizontal applications in interior and exterior spaces
- ▶ Applied from the direction where water comes from
- ▶ Under-ceramic and tile insulation
- ▶ In wet areas such as toilets, bathrooms, kitchens and balconies
- ▶ Water vapor permeable
- ▶ Application should be done with a steel trowel
- ▶ Fiber reinforced
- ▶ 3-3.50 kg/m² for 2mm application
- ▶ NOT APPLIED with an insulation brush
- ▶ Used by mixing 20 kg of powder with 5 kg of liquid
- ▶ Water should not be added to the mixture
- ▶ Complies with EN 14891-2017 Standard.

Packaging: 20 Kg Powder, 5 Kg Liquid, 25 Kg Set



TERAFLEKS 2K-110 FULLY ELASTIC

DOUBLE MIX INSULATION

- ▶ Cement and acrylic based, two-component, fully flexible insulation material.
- ▶ Bridges shrinkage cracks due to its high elasticity.
- ▶ Water vapor permeable.
- ▶ Protects concrete against carbonation.
- ▶ Resistant to underground chemicals and salt solutions.
- ▶ Resistant to freezing and thawing.
- ▶ Can be used in areas affected by vibration due to its elastic structure.
- ▶ 20 kg powder to 10 kg liquid.
- ▶ Water should not be added to the mixture.
- ▶ Fiber reinforced.
- ▶ 3-3.50 kg/m² for 2mm application.
- ▶ Complies with EN 14891: 2017 Standard.

Packaging: 20 Kg Powder, 10 Kg Liquid, 30 Kg Set





TERAFLEKS 2K-106 SEMI-ELASTIC

CM01P

DOUBLE MIX INSULATION

- ▶ Cement and acrylic based, two-component, semi-flexible insulation material.
- ▶ For vertical and horizontal applications in interior and exterior spaces.
- ▶ Applied from the direction of water ingress.
- ▶ Underneath ceramic and tile insulation.
- ▶ In wet areas such as toilets, bathrooms, kitchens and balconies.
- ▶ It is water vapor permeable.
- ▶ Application should be done with an insulation brush.
- ▶ It is used by mixing 20 kg of powder with 6 kg of liquid.
- ▶ Water should not be added to the mixture.
- ▶ It is fiber-reinforced. ▶ For 2mm application, 3-3.50 kg/m²
- ▶ Complies with EN 14891-2017 Standard.

Packaging: 20 Kg Powder, 6 Kg Liquid, 26 Kg Set



ULTRAFLEX 2K 220

SUPER ELASTIC INSULATION MORTAR

- ▶ Cement and acrylic based, two-component, super elastic insulation material.
- ▶ For vertical and horizontal applications in interior and exterior spaces.
- ▶ Applied from the direction of water ingress.
- ▶ For insulation under ceramics and tiles.
- ▶ In wet areas such as toilets, bathrooms, kitchens and balconies.
- ▶ It is water vapor permeable.
- ▶ Application should be done with a steel trowel.
- ▶ It is fiber-reinforced.
- ▶ 3-3.50 kg/m² for 2mm application.
- ▶ NOT APPLIED with an insulation brush.
- ▶ Used by mixing 10 kg of powder with 10 kg of liquid.
- ▶ Do not add water to the mixture.
- ▶ Complies with EN 14891-2017 Standard

Packaging: 10 Kg Powder, 10 Kg Liquid, 20 Kg Set



ELASTIC DOBBY INSULATION FELT

SUPER ELASTIC INSULATION MORTAR

- ▶ Aslan Teraflex 2K 105, Teraflex 110, Teraflex 2K UV and Liquid Membrane are suitable for application.
- ▶ It is an elastic reinforcement used as a reinforcement in surfaces with a risk of cracking and in floor/wall joints.
- ▶ It is used in the insulation of wet areas, balconies and terraces, roof gutters, chimney and light well connections.
- ▶ It is used in bevels at floor-wall joints, in the repair of static cracks in concrete, and in detail transitions such as water drain ventilation chimneys and steel structures.

Packaging: 20cm X 100 m, 25cm X 100 m ,75cm X 100 m, 100cm X 100 m



ALUCOAT

ALUMINUM GOLD PAINT

- ▶ Used as a reflector on carpet-type insulation
- ▶ Solvent-based
- ▶ Cannot be applied to metal surfaces
- ▶ 1 bucket cover 200 m²

Packaging: 15 L, 2.5 L, 0.75 L.



IZO PRIMER 100

INSULATION PRIMER

- ▶ Aslan Liquid Insulation (Acrylic) and Aslan Teraflex (Acrylic-Cement)
- ▶ This is a primer applied to concrete surfaces before the application of brush-on type insulation.
- ▶ It ensures excellent adhesion of the insulation to the concrete.
- ▶ It strengthens the existing aged concrete surface and prevents the insulation from peeling off the concrete.
- ▶ This primer must be allowed to dry on the concrete before proceeding with the new insulation application.
- ▶ It is not suitable for application on carpet-type membrane insulation (tar paper). Aslan Forever Primer must be used for carpet-type insulation.
- ▶ Ready to use, do not dilute.
- ▶ Consumption is 0.100-0.200 lt/m² depending on surface absorbency.

Packaging: 15 L, 2.5 L, 0.75 L.



FOREVER ASTAR

SOLVENT-BASED INSULATION PRIMER

- ▶ This is a primer applied before applying Aslan Liquid Membrane insulation (Acrylic) or brush-on bitumen insulation over carpet-type insulation.
- ▶ It ensures that the new insulation adheres perfectly to the carpet-type membrane.
- ▶ The new insulation application can be started immediately after the primer application.
- ▶ It is ready to use.
- ▶ Consumption is 0.100-0.200 lt/m² depending on the surface absorbency.

Packaging: 15 L, 2.5 L, 0.75 L.



CRISTASEAL 300

CRYSTALLIZED INSULATION

- ▶ It is a cement-based, single-component, crystallizing waterproofing material.
 - ▶ It is used in elevator shafts, water tanks, swimming and ornamental pools.
 - ▶ It is mainly used in negative and positive waterproofing of structures such as basement walls and basement retaining walls.
 - ▶ Thanks to its crystallization property, it effectively prevents water penetration from the surface.
 - ▶ It is resistant to positive and negative water pressure.
- It is easy to use, just mix with water and use.
- ▶ It has a consumption of 1.0-2.0 kg per 1 m².

Packaging: 20 Kg



HYDROCEM PUTZ WTA 100

PLASTER FOR DAMP WALLS

- ▶ This is a specially formulated plaster for walls showing signs of salt efflorescence, paint blistering, dampness, and condensation.
- ▶ After scraping off the existing plaster layer,
- ▶ ASLAN HYDROCEM PUTZ WTA 100 should be applied in a thickness of 1.5 - 2.0 cm.
- ▶ For a satin finish, ASLAN HYDROCEM PUTZ WTA-5 should be applied.
- ▶ Provides 3-stage protection.
- ▶ Complies with EN 998-1 Standard.
- ▶ Consumption is 12 kg per 1 cm in 1 m².

Packaging: 20 Kg

Color: Grey



HYDROCEM PUTZ WTA 5

PLASTER FOR DAMP WALLS

- ▶ It is a satin finish.
- ▶ Consumption: 1.40 kg per m² depending on the smoothness of the substrate.
- ▶ Complies with EN 998-1 standard.

Packaging: 20 Kg

Color: Grey



GROUT FILLER CONSUMPTION TABLE

CERAMIC DIMENSIONS	CONSUMPTION TABLE FOR CEMENT-BASED JOINT FILLERS JOINT DEPTH 8 mm			
	2 MM (GR/M ²)	3 MM (GR/M ²)	4 MM (GR/M ²)	5 MM (GR/M ²)
10X10	0.350	0.400	1000	1250
10X20	0.300	0.350	0.750	0.500
15X15	0.250	0.300	0.450	0.800
15X20	0.200	0.550	0.300	0.750
20X20	0.200	0.250	0.500	0.700
20X25	0.200	0.750	0.550	0.600
20X30	0.250	0.350	0.500	0.550
25X40	0.500	0.450	0.600	0.900
30X30	0.150	0.250	0.350	0.450
33X33	0.150	0.200	0.250	0.450
60X60	0.080	0.150	0.200	0.225
30X60	0.180	0.250	0.320	-
60X120	0.80	0.120	0.160	-
75X75	0.100	0.150	0.200	-
80X80	0.90	0.140	0.190	-
90X90	0.80	0.130	0.180	-
100X100	0.70	0.110	0.160	-
120X120	0.60	0.100	0.140	-
120X240	0.40	0.70	0.100	-
160X320 (slab)	0.30	0.50	0.80	-

DUVARTEKS MORTAR CONSUMPTION TABLE

WALL MATERIAL	WALL MORTAR CONSUMPTION TABLE			
	Width(MM)	Length(MM)	LOAD (MM)	CONSUMPTION KG/M ²
BRICK	85	190	190	14
BRICK	135	190	190	21
ISOLATED BRICK	145	240	235	18
CONCRETE BRICKET	190	240	235	23
BIMS BLOCK	190	390	195	21
BIMS BLOCK	150	390	185	18
BIMS BLOCK	190	390	185	21

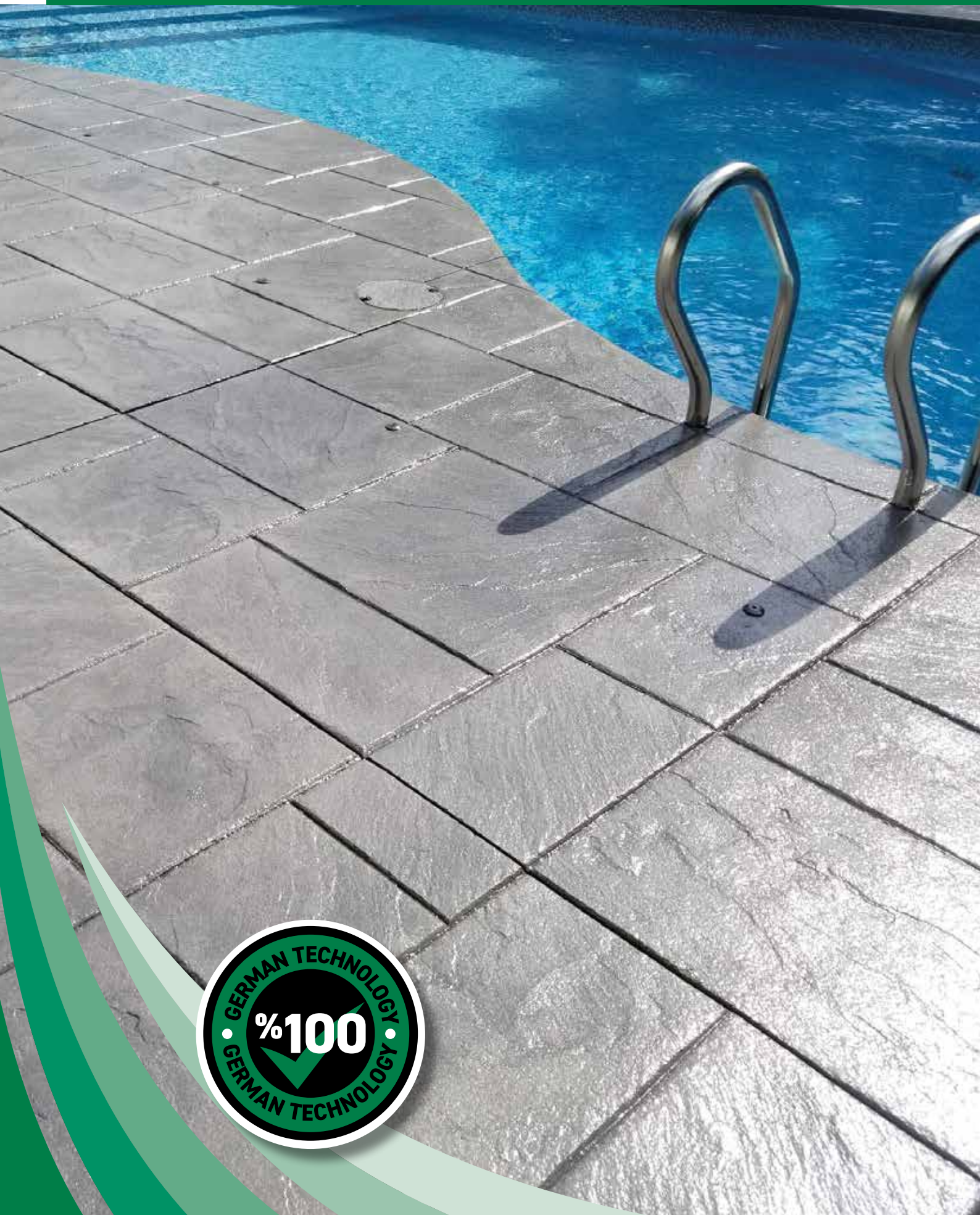

FLOOR SYSTEMS

- ▶ CONCRETE FLOOR CLEANING SYSTEMS
- ▶ INDUSTRIAL FLOOR SYSTEMS
- ▶ STAMPED CONCRETE AND WALL SYSTEMS
- ▶ CONCRETE STRENGTHENING

MULTICLEAN

INDUSTRIAL MOLD CLEANER

- ▶ Used for mold and mildew cleaning
- ▶ Prevents new mold and mildew formation
- ▶ Suitable for use on concrete, walls and ceramics
- ▶ Penetrates concrete and plaster surfaces quickly
- ▶ Prepares a suitable surface for new surface application on concrete

Packaging: 20 Kg, 5 Kg



SUPER BETOSID CLEAN

CONCRETE SURFACE FLOOR CLEANING ACID

- ▶ Used for cleaning before floor painting
- ▶ Removes dirt and debris that may prevent the paint from adhering to the surface
- ▶ Roughens the concrete surface, increasing paint adhesion.

Packaging: 20 Kg, 5 Kg



EFFLOCLEAN

SURFACE FLOWERING CLEANER

- ▶ It is used for cleaning white spots (blooming) that form on concrete surfaces.
- ▶ This product is acid-based. Use rubber gloves and rubber boots during application.
- ▶ It increases the adhesion of the surface by making the concrete surface rough. After application, the concrete floor should be washed
- ▶ IMMEDIATELY with clean water.

Packaging: 20 Kg, 5 Kg



BETOCLEAN

CONCENTRATED CONCRETE FLOOR OIL REMOVER

- ▶ It is used to clean oils from surfaces before "floor painting".
- ▶ Suitable for concrete, ceramic and other previously painted surfaces.
- ▶ Cleans all types of engine and frying oils from concrete and ceramic floors.

Packaging: 20 Kg, 5 Kg



CONCENTRATED CONCRETE CLEANING ACID

- ▶ It is used for cleaning the surface before applying paint or other coatings. It is a concentrated acid.
- ▶ Wear gloves and rubber boots when using it.
- ▶ It cleans dirt and debris from the surface.
- ▶ It roughens the concrete surface, increasing the adhesion of the new surface.

Packaging: 20 Kg

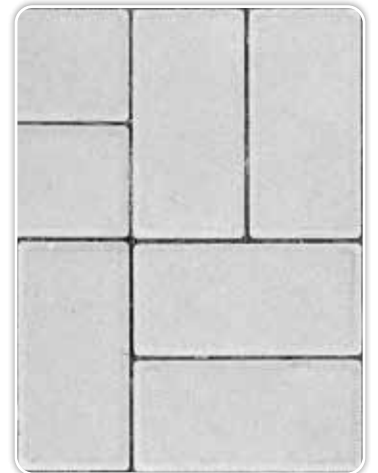

BETO-KUR 201

CURE MATERIALS

- ▶ Acrylic-based curing agent for freshly poured concrete
- ▶ Reduces shrinkage cracks caused by rapid drying on the surface
- ▶ 0.300 kg per 1 m²
- ▶ Economical type.

Packaging: 20 Kg



BETO-KUR E-300

CURE MATERIALS

- ▶ Acrylic-based curing material for freshly poured concrete
- ▶ Reduces shrinkage cracks caused by rapid drying on the surface
- ▶ 0.300 kg per 1 m²
- ▶ Prevents drying on the surface of freshly poured concrete.
- ▶ Reduces the risk of dusting. Prevents cracking on the surface..

Packaging: 20 Kg, 5 Kg, 1 Kg



BETONEX UNDCL

LIQUID FLOOR HARDENER

- ▶ For concrete and screed surfaces
- ▶ Waterproof liquid floor hardener
- ▶ Increases resistance to dusting and abrasion on the surface
- ▶ The effect it gives to the applied surface is permanent
- ▶ On smooth surfaces: Between 0.100-0.200 kg per 1 m²
- ▶ On troweled surfaces: 0.200 kg per 1 m².

Packaging: 15 L (12 Kg), 2.5 L, 1 L



PARKESAP 100

LEVELING SCAR ON DRY SCAR

- ▶ Leveling screed suitable for parquet flooring over dry screed
- ▶ Provides a suitable sub-base for parquet
- ▶ Can be applied to thicknesses of 3-10 mm
- ▶ 1.6 kg per 1 m²

Packaging: 20 Kg

Color: Grey



UNIPLAN SL 100

HIGH-STRENGTH SELF-LEVELING SCREED

- ▶ Cement-based self-leveling screed
- ▶ Workplace and warehouse floors
- ▶ Walkable after 5 hours
- ▶ Fine aggregate
- ▶ Can be applied in thicknesses of 3-10 mm
- ▶ 1.6 kg per 1 mm per 1 m²

Packaging: 20 Kg

Color: Grey



UNIPLAN SL 105

SELF-SPREADING ALUM

- ▶ Cement-based self-leveling screed
- ▶ Workplace and warehouse floors
- ▶ Walkable after 8 hours
- ▶ Can be applied in thicknesses of 6-15 mm
- ▶ 1.7 kg per 1 mm per 1 m²

Packaging: 20 Kg

Color: Grey



UNIPLAN SL 200

SELF-SPREADING ALUM

- ▶ Cement-based self-leveling screed
- ▶ For residential floors
- ▶ Walkable after 24 hours
- ▶ Can be applied in thicknesses of 10-20 mm
- ▶ 1.6 kg per 1 mm per m²

Packaging: 20 Kg

Color: Grey



UNIPLAN SL 205

SELF-SPREADING ALUM

- ▶ Cement-based self-leveling screed
- ▶ For residential floors
- ▶ Walkable after 24 hours
- ▶ Can be applied in thicknesses of 20-50 mm
- ▶ 1.7 kg per 1 mm per m²
- ▶ 1.6 kg per 1 mm per m²

Packaging: 20 Kg

Color: Grey



UNIPLAN LEVEL 301

READY-MADE SCREED MATERIAL FOR HIGH FLUID HEATING SYSTEMS WITHOUT GAPS

- ▶ Cement-based self-leveling screed
- ▶ Workplace and warehouse floors
- ▶ Walkable after 5 hours
- ▶ Fine aggregate
- ▶ Can be applied in 3-10 mm thickness
- ▶ 1.6 kg per 1 mm per m²
- ▶ Depending on the surface to be coated and the application method, average consumption is 15 kg per m² for a 10 mm thickness
- ▶ Complies with EN 13813 Standard.

Packaging: 40 Kg



SAPMATIK LW 400

LIGHTWEIGHT FLUID HIGH QUALITY SCREED MATERIAL

- ▶ Cement-based self-leveling screed
- ▶ For workplace and warehouse floors
- ▶ Walkable after 8 hours
- ▶ Consumption depends on the surface to be covered and the application method
- ▶ Average consumption is 15 kg per 1 m² for a 10 mm thickness.
- ▶ Complies with EN 13813 Standard.

Packaging: 40 Kg



UNIPLAN PRIMER

PRIMER FOR ABSORBENT SURFACES

- ▶ Acrylic-based primer for absorbent surfaces
- ▶ Applied before self-leveling screed
- ▶ Ready to use
- ▶ 100-200g per 1m²

Packaging: 15 L

Color: Transparent



UNIPLAN COLORED

HIGH-STRENGTH SELF-LEVELING SCREED

- ▶ Cement-based self-leveling COLORED screed
- ▶ For decorative purposes indoors and outdoors
- ▶ Suitable for homes and workplaces
- ▶ Manufactured with high durability for heavy use
- ▶ Walkable after 8 hours
- ▶ Can be applied in thicknesses of 6-15mm
- ▶ Consumption is 1.7kg per 1mm per 1m²

Packaging: 20 Kg

Color: White, Fossil-1, Fossil-2



FLOOR 200

FLOOR HARDENER

- ▶ Quartz aggregate floor hardener
- ▶ Reduces surface abrasion by 2-4 times
- ▶ Specially developed for use when applying helicopter heat to freshly poured concrete
- ▶ 5 kg per 1 m²

Packaging: 25 Kg

Color: Cement Grey, Grey, Sun Buff, White



FLOOR Q400

FLOOR HARDENER

- ▶ Quartz aggregate floor hardener
- ▶ Reduces surface abrasion by 2-4 times
- ▶ Specially developed for use when applying helicopter heat to freshly poured concrete
- ▶ 5 kg per 1 m²

Packaging: 25 Kg

Color: Cement Grey, Grey, Sun Buff, White



ANTIQUÉ QU

STAMPED CONCRETE SURFACE HARDENER

- ▶ It is a coloring agent and surface hardener for stamped concrete systems.
- ▶ It can be produced in various colors.
- ▶ 3 kg per 1 m² in areas with pedestrian traffic.
- ▶ 5 kg per 1 m² in areas with vehicular traffic.

Packaging: 25 Kg

Color: Gold, White, Grey, Silver Grey, Sun Buff, Hardwood Red, Sun Light, Dark Grey, Halvel-Sun, Brown, Cyprus Stone, Light Brown Terracotta, Cream, Anthracite Grey, Mocha, Bisquit, Burgundy Autumn Brown, Black



ANTIQUÉ RA

PRINTED CONCRETE MOLD RELEASE POWDER

- ▶ It is a powder product that acts as a mold release agent and provides an aged look for stamped concrete floor systems.
- ▶ It prevents floor molds from sticking to the concrete.
- ▶ 200-400 gr is applied per 1 m².

Packaging: 15 Kg

Color: White, Cyprus Stone, Light Brown, Grey, Terracotta, Halvel-Sun, Red, Black, Dark Brown



ANTIQUÉ RA LIQUID

STAMPED CONCRETE FORM RELEASE LIQUID

- ▶ It is a liquid mold release agent and aged look-giving liquid product for floor printing systems.
- ▶ It prevents floor printing molds from sticking to the concrete.
- 200g per 1m²
- ▶ May vary depending on the application mold. It prevents the molds to be used from sticking to the surface.

Packaging: 15 L, 5 L



PRIMER WET 250

PRIMER THAT STRENGTHENS BONDING

- ▶ Special dispersion-based
- ▶ High adhesion properties
- ▶ Single-component wet-in-wet application special primer that strengthens bond strength.
- ▶ It is a primer applied before Antique Wall application.
- ▶ It is used as a primer applied to the underside of products where high adhesion strength is desired.

Packaging: 20 Kg, 10 Kg, 3 Kg, 1 Kg



ANTIQUÉ WALL

WALL PRINTING PLASTER

- ▶ Wall printing decorative systems: colored, moldable special plaster
- ▶ Can be produced in various colors
- ▶ Consumption varies depending on the thickness to be used.
- ▶ 12 kg per 1 m² (1 cm)
- ▶ Primer Wet 250 primer should be applied before application.

Packaging: 25 Kg

Color: White, Silver Grey, Concrete, Cyprus Stone, Sun Buff, Terracotta Autumn Brown, Grey, Biscuit



STONE CARPET

A DECORATIVE, DURABLE AND IMPERMEABLE FLOOR COVERING SYSTEM

- ▶ It is resistant to impact and abrasion.
- ▶ It is resistant to common household cleaners, oils, and seawater.
- ▶ It is UV resistant; it does not yellow.
- ▶ It is suitable for long-term pedestrian and light vehicle traffic (home garages).
- ▶ It provides a naturally unique appearance.
- ▶ It is adaptable to architectural design.

Packaging:

1 kg+ 0,5 kg+ 12,5 kg= 26,5 kg

1 kg+ 0,85 kg+ 12,5 kg= 26,85 kg



STONE CARPET
COLOR CHART
SCAN THE QR CODE

STONE PRIMER

CURING AND PRIMER FOR CONCRETE SURFACES

- ▶ For interior and exterior surfaces
- ▶ Solvent-based transparent primer that prevents curing and dusting
- ▶ It is a special primer that is applied as the first coat under the topcoat varnishes, increasing the durability and gloss of the varnish
- ▶ 1 liter cover 4 m²
- ▶ Ready to use

Packaging: 15 L, 2.5 L, 0.75 L

Color: Transparent



STONE VARNISH

SOLVENT-BASED GLOSS VARNISH

- ▶ Gloss varnish for stamped concrete and stone surfaces
- ▶ Solvent-based
- ▶ Glossy finish
- ▶ 0.200 kg per 1 m²

Packaging: 15 L, 2.5 L, 0.75 L

Color: Transparent Glossy, Transparent Matte



FLOOR 1K FLOOR PAINT

SINGLE-COMPONENT ACRYLIC-BASED FLOOR PAINT

- ▶ Highways, main and secondary city roads
- ▶ Airports, bridges
- ▶ Residential and shopping centers
- ▶ Used in furniture such as paving stones and curbs.

Packaging: 15 L, 2.5 L, 0.75 L

Color: Transparent



FLOOR 1K FLOOR PRIMER

SINGLE-COMPONENT SOLVENT-BASED FLOOR PRIMER

- ▶ It is a single-component, transparent, high-strength, ready-to-use floor primer.
- ▶ Prevents dusting.
- ▶ Cures quickly.
- ▶ Has surface strengthening properties.

Packaging: 12 L, 2.5 L, 0.75 L

Color: Transparent



FLOOR GUARD

SINGLE-COMPONENT ACRYLIC-BASED FLOOR PAINT

- ▶ Highways, main and secondary city roads
- ▶ Airports, bridges
- ▶ Residential and shopping centers
- ▶ Used in furniture such as paving stones and curbs.

Packaging: 15 L, 2.5 L, 0.75 L

Color: Transparent



PROAQUA VARNISH GLOSS

GLOSS

WATER-BASED GLOSS VARNISH

- ▶ Glossy varnish for concrete and stone surfaces
- ▶ Water-based
- ▶ Does not change the color of the surface it is applied to
- ▶ Does not leave car tire marks on it
- ▶ 0.200 kg for 1 m²

Packaging: 12 L, 7.5 L, 2.5 L, 0.75 L



PROAQUA VARNISH MAT

MAT

WATER-BASED MATTE VARNISH

- ▶ Matte varnish for concrete and stone surfaces
- ▶ Water-based
- ▶ Does not change the color of the surface it is applied to
- ▶ Does not leave car tire marks on it
- ▶ 0.200 kg for 1 m²

Packaging: 12 L, 7.5 L, 2.5 L, 0.75 L



PROAQUA VARNISH SILICONE

SILICONE

WATER-BASED GLOSS SILICONE VARNISH

- ▶ Glossy silicone varnish for concrete and stone surfaces.
- ▶ Water-based.
- ▶ Reinforced with silicone. ▶ Does not change the color of the surface it is applied to.
- ▶ Does not leave car tire marks on it.
- ▶ 0.200 kg for 1 m²

Packaging: 12 L, 6 L, 2 L



ANTIQUÉ RENOVART

VARNISH FOR AN AGED EFFECT

- ▶ Used to renew the appearance of old stamped concrete surfaces.
- ▶ Repairs the lost aged effect on the surface.
- ▶ Restores lost shine.

Packaging: 15 L, 7.5 L, 2.5 L, 1 L



**ANTIQUÉ RENOVART
BEFORE APPLICATION**



**ANTIQUÉ RENOVART
AFTER APPLICATION**

BETOFLOOR

DECORATIVE STAMPED CONCRETE COATING MORTAR TO BE APPLIED TO OLD CONCRETE SURFACES

- ▶ It is used to renew the appearance of old stamped concrete surfaces.
- ▶ It is applied to the existing concrete surface with the thickness of the mold model to be applied, together with the system primer, and takes the shape of the selected decorative mold to obtain the image.
- ▶ It creates a surface resistant to abrasion and impacts.
- ▶ It is resistant to vehicle and pedestrian traffic.
- ▶ It bonds to the surface with high bond strength and integrates with the old concrete.

Packaging: 25 Kg

Color: Silver Gray, Cyprus Stone, Sunlight



**BETOFLOOR
BEFORE APPLICATION**



**BETOFLOOR
AFTER APPLICATION**



KRATOS MICRO NY66

- ▶ It is a synthetic fiber reinforcement that gives successful results in preventing long-term drying shrinkage cracks in fresh concrete.
- ▶ The formation of heat and shrinkage-related cracks is minimized, and higher structural integrity is ensured.
- ▶ EN 14889-2 Class 1 standard.

Packaging: 400 gr - 6mm Length, 600 gr - 12 mm Length



FIBER SYNTHETIC FIBER REINFORCEMENT KRATOS 54MM

- ▶ With its 3D homogeneously distributed fiber design within the concrete, it increases the load-bearing capacity of the concrete and ensures effective crack control at every point.
- ▶ With its easy mixing and quick application advantages, it is used in many application areas in the construction sector, from industrial site concretes to screed concretes.
- ▶ In 3KG packages.

Packaging: 3 Kg - 54 mm length





MACHINE AND MANUAL PLASTERING PLASTER GROUP

- ▶ CEMENT-BASED PLASTERS
- ▶ CEMENT-BASED MACHINE PLASTERS

PERLITEKS 10

EN 998-1: 2016 GP, CSI,W1

PERLITE CEMENT PLASTER

- ▶ Saves time on construction sites for interior surfaces
- ▶ Developed for use instead of plaster/satin
- ▶ Easier to apply than plaster
- ▶ Cannot be used with plaster products
- ▶ Easier to apply than plaster-based products
- ▶ Suitable for application on Perliteks and Perlimatik
- ▶ Does not crack in applications on aerated concrete
- ▶ Applied and finished with a steel trowel
- ▶ Not suitable for foaming
- ▶ Can be applied up to a thickness of 5mm at the minimum and 10mm at the maximum
- ▶ On Perliteks and Perlimatik, the consumption is 3.3kg for 3mm per 1m². EN 998-1: 2016 GP,CSI,W1.

Packaging: 30 Kg

Color: White



PERLITEKS 15

EN 998-1: 2016 GP,CSII,W0

CEMENT AND PERLITE-BASED PLASTER

- ▶ For interior surfaces
- ▶ Easier to apply than gypsum-based products
- ▶ Plaster for brick and aerated concrete surfaces
- ▶ Does not crack when applied over aerated concrete
- ▶ Finished with a steel trowel or level
- ▶ Has insulation properties
- ▶ Can be applied up to a maximum of 25 mm
- ▶ 3.3 kg for 3 mm per 1 m²
- ▶ EN 998-1: 2016 GP,CSII,W0

Packaging: 30 Kg

Color: White



PERLITEKS 20

EN 998-1: 2016 GP, CSII,W0

PERLITE-BASED LIGHTWEIGHT COARSE PLASTER

- ▶ For interior surfaces
- ▶ Easier to apply than gypsum-based products
- ▶ Plaster for application on brick, pumice, block and aerated concrete
- ▶ Does not crack when applied on aerated concrete
- ▶ Finished with steel trowel or level
- ▶ Can be applied up to 5-10 cm in one go.
- ▶ Can be applied up to a maximum of 50 mm
- ▶ Has insulation properties
- ▶ High filling power plaster
- ▶ 10 kg per 1 cm in 1 m²
- ▶ EN 998-1: 2016 GP,CSII,W0

Packaging: 30 Kg **Color:** White



IT IS LIGHT



SIVAPER

EN 998-1: 2016 GP,CSI,W0

CEMENT-BASED THIN WALL LEVELING PLASTER

- ▶ For interior surfaces
- ▶ Provides easy application
- ▶ High workability
- ▶ Developed for use instead of plaster
- ▶ Easier to apply than plaster
- ▶ Cannot be used with plaster products
- ▶ Suitable for application only on second-coat rough plaster
- ▶ Applied and finished with a steel trowel
- ▶ Not suitable for foaming
- ▶ Can be applied up to a minimum thickness of 5mm and a maximum thickness of 10mm
- ▶ Consumption is 3.3kg for 3mm on 1m² of second-coat rough plaster.
- ▶ EN 998-1: 2016 GP,CSI,W0

Packaging: 25 Kg **Color:** White



SATENPER 5

EN 998-1: 2016 GP,CSI,W0

CEMENT-BASED SATIN FINISHING PLASTER

- ▶ For interior surfaces
- ▶ Developed to replace satin plaster
- ▶ Easier to apply than satin plaster
- ▶ Suitable for application on Perliteks, Perlimatik and Sivateks
- ▶ Does not crack in applications on aerated concrete
- ▶ Cannot be used with plaster products
- ▶ Applied and finished with a steel trowel
- ▶ Can be applied up to a minimum thickness of 2mm and a maximum thickness of 4mm
- ▶ Consumption on Perliteks, Perlimatik and Sivateks is 1.33kg per 1m² for 1mm. EN 998-1: 2016 GP, CSI, W0

Packaging: 30 Kg **Color:** White



EUROPER

THIRD COAT PLASTER WITH SILICONE AND FIBER REINFORCEMENT

- ▶ For exterior surfaces.
- ▶ Contains silicone and fiber reinforcement.
- ▶ Suitable for application only on second coat rough plaster.
- ▶ Applied with a steel trowel.
- ▶ Finished by smoothing with a sponge.
- ▶ Can be applied in a single coat up to a maximum thickness of 6mm.
- ▶ Consumption is 3kg for 4.5mm on 1m² of second-coat rough plaster.
- ▶ Developed especially for Perliteks series systems.

Packaging: 30 Kg

Color: White



ASMOTHERM

EN 998-1: 2016 GP, CSII, W0

CEMENT AND PERLITE-BASED PLASTER

- ▶ For ceilings
- ▶ It is sheet plaster for EPS hollow block floors
- ▶ It is fiber-reinforced and should be used with insulation mesh.
- ▶ It can be applied by machine or by hand
- ▶ If the surface requires filling, Asmoteks 20 is used,
- ▶ If it is smooth, Asmoteks 15 is used
- ▶ It is resistant to moisture and humidity
- ▶ It can be used up to a maximum of 6mm
- ▶ 5kg per 1 m²
- ▶ EN 998-1: 2016 GP, CSII, W0

Packaging: 30 Kg

Color: White



ASMOTEKS 20

EN 998-1: 2016 GP, CSII, W0

CEMENT-BASED ASMOLE PLASTER

- ▶ For ceilings
- ▶ Machine and hand application
- ▶ Easier to apply than gypsum-based products
- ▶ Specially produced for EPS and aerated concrete hollow block floors
- ▶ Lightweight plaster developed for surfaces where filling is desired on ceiling surfaces
- ▶ Resistant to moisture and humidity.
- ▶ Protects the applied surface from fire up to 600°C.
- ▶ Applied up to a maximum of 100 mm
- ▶ 7 kg per 1 cm in 1 m²
- ▶ High filling power, easy to prime
- ▶ Fire resistant
- ▶ EN 998-1: 2016 GP, CSII, W0

Packaging: 15 Kg **Color:** White



ASMOTEKS 15

EN 998-1: 2016 GP, CSII, W0

CEMENT-BASED MACHINE-MADE ASMOLE PLASTER

- ▶ For ceilings
- ▶ Third coat plaster
- ▶ Can be applied by machine and by hand
- ▶ Easier to apply than gypsum-based products
- ▶ Specially produced for EPS and aerated concrete hollow block floors
- ▶ Resistant to moisture and humidity.
- ▶ Protects the applied surface from fire up to 600°C.
- ▶ Applied up to a maximum of 10 mm
- ▶ 3.3 kg for 3 mm per 1 m²
- ▶ EN 998-1: 2016 GP, CSII, W0

Packaging: 15 Kg **Color:** White



ASMOTHERM ZERO

EN 998-1: 2016 GP, CSII, W0

CEMENT AND PERLITE-BASED PLASTER

- ▶ For ceilings
- ▶ It is sheet plaster for EPS hollow block floors
- ▶ It is fiber-reinforced and should be used together with insulation mesh.
- ▶ It can be applied by machine or by hand
- ▶ If the surface requires filling, Asmoteks 20 is used,
- ▶ If it is smooth, Asmoteks 15 is used
- ▶ It is resistant to moisture and humidity
- ▶ Maximum thickness of 6mm can be used
- ▶ 5kg per 1 m²
- ▶ EN 998-1: 2016 GP, CSII, W0

Packaging: 20 Kg

Color: White



SIVAMIX MHL 200R

EN 998-1: 2016 GP, CSIII, W0

CEMENT-BASED MACHINE-APPLIED READY-MADE PLASTER

- ▶ Used on interior and exterior surfaces and in wet areas
- ▶ Ready-to-use machine plaster
- ▶ Applied to brick, aerated concrete and block surfaces
- ▶ Easy to level
- ▶ Can be applied up to a maximum of 25 mm
- ▶ 15-16 kg per 1 cm in 1 m²
- ▶ EN 998-1: 2016 GP, CSIII, W0

Packaging: 40 Kg

Color: White

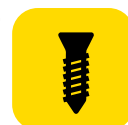

D 8-2 - 2 L 6
2 L 6 PLUS



PERLIMATİK 20

EN 998-1: 2016 GP, CSII, W0

CEMENT AND PERLITE-BASED MACHINE PLASTER

- ▶ For interior surfaces
- ▶ Machine-made plaster
- ▶ Easier to apply than gypsum-based products
- ▶ Plaster for pumice, block, brick and aerated concrete surfaces
- ▶ Does not crack on aerated concrete and pumice
- ▶ Finished with a trowel
- ▶ Can be applied up to a maximum of 25 mm
- ▶ 10 kg per 1 cm in 1 m²
- ▶ EN 998-1: 2016 GP, CSII, W0

Packaging: 30 Kg

Color: White



SIVAMIX M 100

EN 998-1: 2016 GP,CSIII,W0

CEMENT-BASED MACHINE PLASTER

- ▶ Used on interior and exterior walls and in wet areas
- ▶ Ready-to-use machine plaster
- ▶ Applied to brick, aerated concrete and block surfaces
- ▶ Easy to level
- ▶ Can be applied up to a maximum of 25 mm
- ▶ 15 kg per 1 cm in 1 m²

Packaging: 25 Kg, 40 Kg

Color: Grey



SERPMEMIX M 100

EN 998-1: 2016 GP,CSIV,W1

CEMENT-BASED MACHINE-APPLIED SPRAY PLASTER

- ▶ For interior and exterior surfaces
- ▶ Machine-applied spray plaster
- ▶ Suitable for brick, pumice and block
- ▶ 5-8 kg per 1 m²
- ▶ EN 998-1: 2016 GP, CSIV, W1

Packaging: 25 Kg, 40 Kg

Color: Grey



SERPMEMIX MP 100

EN 998-1:2016 GP, CSIV, W0

CEMENT-BASED SPRAY-ON GLOSS SURFACE PLASTER

- ▶ For interior and exterior surfaces
- ▶ It is a spray plaster applied by machine without the need for raw concrete primer application.
- ▶ Suitable for raw concrete column and beam surfaces.
- ▶ 2.5-3 kg per 1 m²
- ▶ EN 998-1:2016 GP, CSIV, W0

Packaging: 40 Kg

Color: Grey



ANOTUT

CEMENT-BASED ADHESIVE FOR ANO PROFILES

- ▶ High initial adhesion strength
- ▶ Fast drying
- ▶ Low adhesion after drying
- ▶ Does not damage the anode when removed

Packaging: 20 Kg

Color: White



CEMENT BASED MACHINE PLASTERS



DECORATIVE COATING AND EFFECT GROUP

- ▶ EXTERIOR FACADE CLADDINGS
- ▶ DECORATIVE FINISHING PLASTERS
- ▶ EFFECT GROUP PRODUCTS



RULOTEX

EXTERIOR FACADE CLADDINGS

COATING THAT GIVES A COARSE-TEXTURED APPEARANCE

- ▶ Acrylic-based decorative coating.
- ▶ Can create patterns.
- ▶ Thinned according to the pattern.
- ▶ Consumption varies depending on the pattern.
- ▶ 1 kg cover 3-5 m² of surface.

Packaging: 20 Kg



TEXTURE KD

EXTERIOR FACADE CLADDINGS

- ▶ Exterior paint.
- ▶ Decorative, thick pattern.
- ▶ Matte finish.
- ▶ Creates a deep textured pattern on the surface.
- ▶ Consumption varies depending on the pattern.
- ▶ Ready to use.
- ▶ 1 kg cover 0.75 m² of surface.

Packaging: 20 Kg, 10 Kg, 3 Kg, 1 Kg



GRAFIATEX PUTZ DECORATIVE FINISHING PLASTERS

- ▶ For exterior facades
- ▶ Cement-based line plaster
- ▶ Can be applied over second-coat rough plaster
- ▶ Can be used as a final decorative plaster in insulation systems.
- ▶ Applied with a steel trowel, finished with a plastic trowel
- ▶ Not applicable to previously painted surfaces
- ▶ Painting the surface after application is not necessary
- ▶ Can be produced in color, please inquire for price
- ▶ Consumption rates are calculated on flat surfaces. Sample application must be done for consumption calculation in projects.
- ▶ EN 998-1: 2016 GP, CSII, W1

Packaging: 25 Kg,

Thickness: Zero, 1,5mm, 2 mm, 3 mm



CEMENTERASIT DECORATIVE FINISHING PLASTERS

- ▶ For exterior surfaces
 - ▶ Cement-based line plaster
 - ▶ Applied with a steel trowel, finished with a plastic trowel
 - ▶ Not suitable for previously painted surfaces
 - ▶ Available in white only, not in colored versions
 - ▶ The surface must be painted after application
 - ▶ Consumption is calculated on flat surfaces.
- Sample application must be done for consumption calculation in projects.
- ▶ EN 998-1: 2016 GP,CSII,W1

Packaging: 25 Kg,

Thickness: 1,5mm, 2 mm, 3 mm



DECOPRIMER 350

DECORATIVE PLASTER PRIMER

- ▶ Prevents water loss on absorbent surfaces
- ▶ Provides high adhesion
- ▶ Can be colored

Packaging: 15 L, 7.5 L, 2.5 L



MARMARITO

MARBLE PATTERNED DECORATIVE PAINT

Acrylic copolymer binder-based, marble-patterned decorative interior paint adds a stylish and modern touch to spaces with its velvety texture and natural marble appearance. Thanks to its high covering power and flexible structure, it does not crack; the glassy surface it creates is easy to wipe clean. Its water-based formula is environmentally friendly and safe for human health. It can be safely applied to many interior surfaces, including concrete, plaster, stucco, and paintable wallpaper.

Packaging: 15 Kg, 7,5 Kg, 2,5 Kg, 1 Kg



ARTECO

ANTIQUÉ PATTERNED DECORATIVE PAINT

Arteco, one of the classic series from the Aslan Effect group, is an aged-style wall paint with a structure that gives a historical-antique look, and its easy and quick application and results.

It is applied to all wood, concrete, concrete panel, convection plaster, etc. surfaces that have been prepared.

Packaging: 12 L, 7,5 L, 2,5 L, 0,75 L



MULTIBASE GLOSS

BACKGROUND PAINT FOR EFFECT PAINTS

This is one of Aslan Effects' multi-purpose products, developed as a background paint for decorative effect paints. It provides excellent adhesion to all types of surfaces and does not crack or peel. Its odorless and environmentally friendly composition makes it safe for interior use. It facilitates the application of decorative effect paints and ensures flawless results.

Packaging: 12 L, 7,5 L, 2,5 L, 0,75 L



MULTIBASE MAT

BACKGROUND PAINT FOR EFFECT PAINTS

This is one of Aslan Effects' multi-purpose products, developed as a background paint for decorative effect paints. It provides excellent adhesion to all types of surfaces and does not crack or peel. Its odorless and environmentally friendly composition makes it safe for interior use. It facilitates the application of decorative effect paints and ensures flawless results.

Packaging: 12 L, 7,5 L, 2,5 L, 0,75 L



ARTECO

Vintage Patterned Decorative Paint



Arteco, one of the classic series from the Aslan Effect group, is an aged-style wall paint with a structure that gives a historical-antique look, and is easy and quick to apply and achieve results.

MARMARITO

Marble Pattern Decorative Paint

Marble-patterned decorative interior paint, with its velvety texture and natural marble look, adds a stylish and modern atmosphere to spaces.



PEARL

DECORATIVE PAINT

This is one of the multi-purpose series from the Aslan Effect group. It can be used as a background on the floor, while in the final coat application it is used for effect purposes..

Packaging: 15 Kg, 10 Kg, 3 Kg, 1 Kg



METALICO

Pure acrylic binder-based, pearlescent, elegant decorative interior paint. Thanks to its pearlescent structure, it offers a bright and special appearance like a pearl. It also allows for different pattern applications. It is washable. Thanks to its water-based structure, it does not harm human health or the environment.

Packaging: 15 Kg, 7,5 Kg, 2,5 Kg, 1 Kg



DECO METALICO

This is an acrylic-based decorative coating with a pearlescent, metallic, or shimmering effect, used for interior and exterior wall decoration. It is highly decorative thanks to the horizontal, vertical, or circular line patterns achieved by changing the direction of the trowel's movement. Because it is solvent-free, it is odorless and does not harm human or environmental health.

Packaging: 15 Kg, 7,5 Kg, 2,5 Kg, 1 Kg
Thickness: Zero, 1,5mm, 2 mm, 3 mm



CRACOS

CRYLIC COPOLYMER BINDER BASED CRACKING LIQUID FOR CRACKING PATTERNS

Cracos creates antique-looking spaces thanks to its crackle patterns, and its water-based formula does not harm human health or the environment. It can be applied to all prepared surfaces, including old painted surfaces, concrete, plaster, stucco, fiber cement boards, fiberglass, and paintable wallpaper.

Packaging: 15 Kg, 7,5 Kg, 2,5 Kg, 1 Kg



MAGICO

COLOR-CHANGING DECORATIVE INTERIOR PAINT BASED ON PURE ACRYLIC BINDER

Magico creates a highly dynamic and vibrant space thanks to its color-changing structure, generating color fluctuations depending on light and movement. It allows for different color combinations and pattern applications simultaneously. It is highly washable and, thanks to its water-based formula, is harmless to human health and the environment.

Packaging: 15 Kg, 7,5 Kg, 2,5 Kg, 1 Kg



TERASIT

DECORATIVE READY-COLORED PLASTER

It is a ready-to-use colored plaster based on acrylic emulsion. It is used as a final decorative coating on the interior and especially the exterior facades of all buildings.

Packaging: 20 Kg, 10 Kg, 3 Kg



TERASIL

SILICONE-BASED DECORATIVE READY-COLORED PLASTER

This is a ready-to-use colored plaster based on acrylic emulsion with silicone additive. Due to its silicone content, it repels water, allowing rainwater to run off the surface without wetting it. It adheres easily and strongly to all surfaces. It is resistant to friction and impacts. Due to its high silicone content, it possesses waterproof and vapor permeable properties. It is used as a final decorative coating on the interior and especially exterior facades of all buildings.

Packaging: 20 Kg, 10 Kg, 3 Kg.



DEKORTEX 100

This is a high-performance, elastic, silicone-modified, acrylic emulsion-based, ready-to-use colored plaster suitable for interior and exterior use. Its textured surface and thickness conceal plaster imperfections. It conforms to TS 7847 Standard. It cover plaster imperfections with its textured surface and thickness. Its vapor permeability allows buildings to breathe. It is unaffected by harsh weather conditions. It does not blister, crack, or change color. Being water-based, it is harmless to human and environmental health.

Packaging: 20 Kg, 10 Kg, 3 Kg



MICROCEMENT FOSSIL 1

This is a polymer-reinforced, marble-look decorative natural coating prepared with special cement and natural fillers. Its polishable structure creates modern, stylish, and smooth surfaces for both interior and exterior use.

Suitable for wall, ceiling, and floor applications. It dries and hardens quickly, providing a durable surface without cracking. High gloss can be achieved using a trowel or mechanical polishing techniques, if desired.

Packaging: 15 Kg, 3 Kg, 1 Kg



MICROCEMENT FOSSIL 2

This is a polymer-reinforced, marble-look decorative natural coating prepared with special cement and natural fillers. Its polishable structure creates modern, stylish, and smooth surfaces for both interior and exterior use.

Suitable for wall, ceiling, and floor applications. It dries and hardens quickly, providing a durable surface without cracking. High gloss can be achieved using a trowel or mechanical polishing techniques, if desired.

Packaging: 15 Kg, 3 Kg, 1 Kg



MICROCEMENT FOSSIL 3

This is a polymer-reinforced, marble-look decorative natural coating prepared with special cement and natural fillers. Its polishable structure creates modern, stylish, and smooth surfaces for both interior and exterior use.

Suitable for wall, ceiling, and floor applications. It dries and hardens quickly, providing a durable surface without cracking. High gloss can be achieved using a trowel or mechanical polishing techniques, if desired.

Packaging: 15 Kg, 3 Kg, 1 Kg



BETONART NATUREL

PLASTER WITH A NATURAL, EXPOSED CONCRETE LOOK

BETONART NATUREL is a polymer-reinforced decorative plaster prepared with special cement and natural fillers. Thanks to its natural raw concrete appearance, it offers a modern and timeless aesthetic on both interior and exterior surfaces. It can be used for wall and floor applications and is resistant to moisture. Due to its natural structure, it does not lose its color over the years; it acquires a characteristic appearance according to the climatic conditions of the environment in which it is applied. It can also be safely used in partial or general repairs of raw concrete surfaces. With its natural texture and strong structure, it is the perfect complement to architectural decorations.

Packaging: 20 Kg, 3 Kg, 1 Kg



BETONART NATUREL DARK

NATURAL EXPOSED CONCRETE LOOK PLASTER - DARK

This is a polymer-reinforced decorative natural plaster produced with special cement and natural fillers. It provides a raw concrete look on interior and exterior surfaces, complementing modern and natural interior designs. Suitable for wall and floor applications, it is moisture-resistant and maintains its appearance for many years thanks to its natural structure. It can also be safely used in partial raw concrete repairs. With its natural texture and strong structure, it is a perfect complement to architectural decorations.

Packaging: 20 Kg, 3 Kg, 1 Kg



BETONART NATUREL S

PLASTER WITH A NATURAL, EXPOSED CONCRETE LOOK

ASLAN BETONART NATUREL S is a polymer-reinforced decorative plaster produced with special cement and natural fillers. Thanks to its natural raw concrete appearance, it creates a modern and aesthetic surface on both interior and exterior walls. It can be used for wall and floor applications. It is resistant to moisture and, thanks to its natural structure, does not lose its color or texture for many years. It creates natural tonal transitions depending on the weather conditions of the environment in which it is applied. It is also safely preferred for partial and general repairs of raw concrete surfaces that have been removed from the mold.

Packaging: 20 Kg, 3 Kg, 1 Kg



GRAIN PLASTER

ACRYLIC-BASED, DECORATIVE GRAIN-TEXTURED EXTERIOR WALL COATING

This is a ready-to-use, decorative finishing plaster based on acrylic resin for exterior facades. Suitable for interior and exterior use, it is water-based, solvent-free, and odorless. It is ready to use and has a high application coverage. It is applied with a trowel. It has high breathability and water vapor permeability. It has strong adhesion to the substrate and is resistant to cracking and peeling.

Packaging: 20 Kg, 10 Kg, 3 Kg



SANTEX

Manufactured using acrylic copolymer binder and natural granite-marble aggregates, this decorative exterior cladding material offers both high durability and aesthetic appeal. It exhibits superior resistance to harsh atmospheric conditions, creating a long-lasting and natural texture on surfaces.

Packaging: 20 Kg





HISTORICAL ARTIFACTS RESTORATION PRODUCTS



NATUREL LIME NHL 2,5

NATURAL HYDRAULIC LIME

It is a ready-made plaster material based on natural hydraulic lime, free of cement, and containing natural silica aggregate and inorganic fibers. It is a natural binder that hardens even underwater (hydraulic). Due to its lower compressive strength, it is preferred in the restoration of soft stones or historical bricks.

Packaging: 15 Kg



NATUREL LIME NHL 3,5

NATURAL HYDRAULIC LIME

NHL 3.5 Natural Hydraulic Lime is a cement-free, breathable, binder-based building material obtained by firing limestones containing clay and minerals. It hardens both in air and water (in a humid environment). It is used especially in the restoration of historical buildings, in the production of Khorasan mortar, and in stone wall plasters to provide durability, flexibility, and moisture balance. It is an ideal "natural" binder for medium-hardness applications.

Packaging: 12 Kg **Color:** Yellow



NATUREL LIME NHL 5

NATURAL HYDRAULIC LIME

It is a ready-made plaster material based on natural hydraulic lime, containing natural silica aggregate and inorganic fibers, used in the restoration and repair works of historical masonry structures, and free of cement.

Packaging: 15 Kg

Color: White/B365 Brown/Y365 Yellow/Brown



HYDROREST WHITE

LIGHT WEIGHT HYDRAULIC LIME-BASED PLASTER

This is a hydraulic lime-based, lightweight perlite-containing interior and exterior restoration plaster for adobe and natural stone walls. It is resistant to temperatures up to 800 degrees Celsius. It is a non-combustible plaster. It exhibits good adhesion to adobe surfaces. It allows the use of a single product for both the undercoat and topcoat. It is fiber-reinforced. It has higher adhesion and durability. It is resistant to moisture and humidity. It has high vapor permeability. It creates a smooth and hard surface. **Packaging: 20 Kg**



HYDROREST WR

LIGHTWEIGHT HYDRAULIC LIME WITH MOISTURE RESISTANCE

It is a high-quality, ready-to-use mixture based on mineral and hydraulic lime perlite, applicable by hand. Due to the additives it contains, it carries moisture from the wall to the outside, ensuring it always appears dry. It has excellent adhesion to mineral-based surfaces. It can be bonded to adobe surfaces. It can be easily stretched and the surface leveled. It has high elasticity. It is resistant to dampness and humidity. By retaining water for a longer period, it ensures rapid drying of the surface and prevents the formation of hairline cracks. Thanks to the fibers it contains, it minimizes the formation of hairline cracks. **Packaging: 20 Kg**



HYDROPLAST 275

HYDRAULIC LIME-BASED COARSE PLASTER

Hydraulic lime, fired at low temperatures and free of cement, for use in the manufacture of Khorasan mortar. **Packaging: 25 Kg**



HYDROPLAST THIN PLASTER

HYDRAULIC LIME-BASED THIN PLASTER

It is a cement-free plaster material based on natural hydraulic lime, containing natural silica aggregate and inorganic fibers, used for plastering historical masonry structures. **Packaging: 20 Kg**
Color: Brown 100-Brown 200



NATUREL NHL NATUREL CYPRUS STONE

**NATURAL HYDRAULIC LIME-BASED
DECORATIVE NATURAL STONE GROUT**

Packaging: 20 Kg

Color: Cyprus Stone02 Grout, Cyprus Stone03 Grout, Cyprus Stone04 Grout



NATUREL NHL INJECT 555

NATURAL HYDRAULIC LIME-BASED INJECTION MORTAR

It is a pre-mixed, cement-free, pozzolanic lime mortar with a very fine grain size (less than 12 µm), exhibiting high fluidity and excellent workability.

Packaging: 20 Kg



HYDROPLAST S 300

HYDRAULIC LIME BASED REPAIR MORTAR

It is a high-strength, thixotropic repair mortar based on pozzolanic lime, cement-free, developed for historical buildings. It does not contain cement. It has high mechanical strength. It has high adhesion strength. The amount of water-soluble salts it contains is limited. It is easy to prepare and apply. It is breathable, has high water vapor permeability. It has low capillary water absorption. It has high resistance to efflorescence.

Packaging: 20 Kg



NATUREL RED

NATURAL RED MINERAL PIGMENT

The natural brick dust (or tile fragments) used in Khorasan mortar is a baked clay-based material that gives the mortar its pozzolanic properties. It is a fundamental component used in historical buildings, especially those requiring water resistance such as cisterns, baths, and domes, often mixed with lime.

Packaging: 25 Kg

Thickness: 0-1 mm / 1-2 mm /2-3 mm



WE ARE PRESERVING THE LEGACY OF THE PAST WITH THE TECHNOLOGY OF THE FUTURE

Every stone has a story,
every building has a soul.
We are preserving this unique
heritage for future generations,
remaining true to its original form.
With our restoration products,
developed using scientific data and
without damaging the historical
fabric, we are bringing centuries-old
structures together with modern
conservation methods.



www.aslanboya.com



BMP TRADE LTD

Haspolat Kirlı Sanayi Bölgesi
Güney Sokak Lefkoşa Kıbrıs

Phone: +90 392 365 65 23

Fax: +90 392 365 06 70

E-mail: info@aslanboya.com



Semra Ltd.

SEMRA LTD

Büyük Sanayi Bölgesi NO:172
Gazimağusa Kıbrıs

Phone: + 90 392 444 80 00

Fax: + 90 392 365 06 70

E-mail: bilg@semragroup.com